



Quality Assurance Statement

The satisfaction of all customers is the fundamental principle of the PROLUBE corporate philosophy.

PROLUBE stand committed to the quality of its products and service with the assurance fo complete back-up support.

With a wide range of products, prompt service and vast experience, PROLUBE remains dedicated to the customer.

PROLUBE

PROLUBE

GREASING EQUIPMENT

GREASE GUNS

- 7** Lever Grease Guns - Heavy Duty
- 8** Lever Grease Gun - Professional
- 9** Lever Grease Guns - Super Value
- 10** Lever Grease Guns - Standard
- 11** Lever Grease Gun - "V" Series
- 12** Lever Oil Gun
- 13** Lever Grease Gun - Japanese Style
- 14** Double Lever Grease Gun
- 15** Pistol Grip Grease Gun - Professional
- 16** "Vario" Premium Pistol Grip Grease Guns
- 17** Dual Discharge Pistol Grip Grease Gun
Ultimate' All Weather Pistol Grip Grease
Guns
- 18** Pistol Grip Grease Guns
- 20** Pistol Grip Grease Gun - V Series
- 21** Quick Connect Pistol Grip Grease Gun
- 22** Clear Tube Lever Grease Gun
- 24** Clear Tube Pistol Grip Grease Gun
- 25** Mini Lever Grease Gun
- 26** Push Type Grease Guns
- 27** Mini Pistol Grease Gun - Deluxe
- 27** Mini Pistol Grease Guns - Popular
- 28** Air Operated Grease Guns
- 30** High Power Air Operated Grease Gun
- 31** 19.2V Battery Powered Grease Gun

GREASE GUN ACCESSORIES

- 32** Hydraulic Couplers & Sets
- 34** Hydraulic Couplers - Heavy Duty
- 34** Hydraulic Coupler - AIR-O
- 35** Hydraulic Couplers - 90°
- 35** Hydraulic Couplers - 360°
- 36** Button Head Couplers
- 37** Hydraulic Couplers - Pin Type
- 37** Needle Nose Dispensers
- 38** Grease Injector Needles
- 38** Seal Off Dispenser
- 39** Grease Gun Holders
- 39** Heavy Duty Grease Gun Holder

- 40** Grease Gun Hoses
- 42** Grease Gun Hoses - Heavy Duty
- 44** Flexible/Rigid Grease Gun Extension
- 44** Grease Gun Extension Swivel
- 45** Grease Gun Steel Extensions
- 45** Grease Gun Light
- 46** Bulk Loaders / Filler Nipples
- 46** Air Release Valves
- 47** Deluxe Steel Bearing Packers

GREASE FEEDERS

- 48** Grease Feeders

GREASE FITTINGS & ACCESSORIES

- 50** Grease Fittings
- 52** Grease Fitting Sets
- 54** Greasing Adaptors & Elbows
- 54** Grease Fitting Thread Tester
- 55** Grease Fitting Caps
- 55** Easy Out Tools
- 56** "Drive Fit" Grease Fitting Installer
- 56** Grease Fitting Unblocker

QUICK LINK

- 57** Quick Connect Adaptors
- 60** Quick Disconnect Adaptor
- 60** Ezee Lube Kit

GREASE PUMPS & ACCESSORIES

- 61** Composite Air Operated Grease Ratio
Pumps 50:1
- 62** Air Operated Grease Ratio Pumps 50:1
- 64** Grease Control Valves - Professional
- 65** Grease Control Valves - Booster
- 66** Grease Control Valves - Metered
- 67** High Pressure Grease Swivels
- 68** Foot Operated Grease Pump
- 69** Portable Greasing System
- 70** Bucket Greasers
- 72** Grease Filler Pump - Professional
- 73** Grease Filler Pumps
- 74** High Pressure Grease Pumps
- 75** Follower Plates
- 76** Female Loader Adaptors

OILING EQUIPMENT

OIL PUMPS & ACCESSORIES

- 78** Lever Action Barrel Pumps
- 79** Lever Action Oil Pump
- 79** Vertical Lift Pump
- 80** Front Action Barrel Pump
- 81** Quart / Litre Stroke Pump
- 82** Rotary Barrel Pumps
- 83** Rotary Barrel Pump - Professional
- 84** Rotary Booster Pump 3:1
- 85** Double Diaphragm Fuel Transfer Pump
- 86** Industrial Rotary Barrel Pumps
- 88** Oil Lube Dispensers
- 89** Spring Loaded Pumps
- 90** Ezee Flo Pump
- 91** Drip Pans
- 91** Bung Nuts
- 92** Suction Tubes
- 93** Composite Air Operated Oil Pum - 5:1
- 94** Air Operated Oil Ratio Pumps
- 96** Air Operated Stainless Steel Pump
- 97** Air Operated Oil Pump Accessories
- 98** Air Operated Double Diaphragm Pumps
- 100** Electric Oil & Fuel Pump

OIL METERS & GUNS

- 102** Electronic Oil Meters
- 103** Mechanical Oil Meters
- 104** Electronic Oil Control Guns
- 105** Mechanical Oil Control Guns
- 106** Electronic Preset Oil Control Gun
- 107** Oil Control Guns
- 108** Oil Control Gun Accessories

OIL PUMP ACCESSORIES

- 109** Oil Spigots
- 110** Suction Guns
- 111** Transfer Gun

OIL CANS & ACCESSORIES

- 112 Oil Cans
- 114 Speciality Oil Cans
- 114 Flexible & Rigid Spouts

OIL MEASURES & FUNNELS

- 115 Flexible Spout Measures
- 116 Smart Funnels

HOSE REELS

- 118 Air Water - Low Pressure Hose Reels
- 118 Oil - Medium Pressure Hose Reels
- 118 Grease - High Pressure Hose Reels

WASTE OIL HANDLING

- Air Operated Double Diaphragm Waste
- 121 Oil Pumps
- 122 Waste Oil Drain - Pressurized
- 123 Waste Oil Drain - Gravity Feed
- 124 Electric Oil Pump
- 125 Low Profile Truck Drain
- 126 Drain Pans

SPECIALITY PUMPS

- 128 Diaphragm / Bilge Pump
- 129 Diaphragm Pump - Food Grade
- 130 Plastic Lever Pump
- 131 Air Operated DEF Transfer Pump
- 132 Plastic Rotary Pumps
- 134 Polypropylene Chemical Pump
- 134 Nylon Chemical Pump
- 135 Siphon Pumps
- 136 Battery Operated Plastic Pump
- 136 Tire Sealant Pump
- 137 Brass Transfer Pumps
- 138 Safety Pumps

AIR LINE

- 141 Air Regulator
- 141 Air Lubricator
- 142 Filter Regulator Combination
- 142 Filter-Regulator & Lubricator - 2 pc
- 143 Air Coupler & Nipple
- 144 Air Line Fittings

DRUM HANDLING

- 146 Drum Dolly
- 146 Drum Dolly - Stainless Steel
- 147 Band Dollies
- 148 Cross brace Lip Dolly
- 148 Drum Wrench
- 149 Drum Cradle
- 150 Low Profile Drum Trolley
- 150 Drum Trolley - Adjustable
- 151 Drum Faucet / Tap
- 151 Drum Bung Converter

WE ARE
CONTINUALLY
EVOLVING...

Over the last four decades, Prolube has imposed an unrivalled quality standard in the manufacturing of Lubrication Equipment. This search for excellence is what drives 'TEAM PROLUBE'. Wherever you deploy your business, whatever your application, we provide you with the best equipment you need.

OUR
PRODUCTS
FIND APPLICATION IN A
VARIETY OF INDUSTRIES



MARINE



WOODWORKING



CONSTRUCTION



ENERGY & POWER



DIY



AEROSPACE & DEFENCE



MINING



INDUSTRIAL & MACHINERY



AUTOMOTIVE



AGRICULTURE



RAILROAD



WORKSHOP



OIL & GAS



CEMENT & STEEL

GREASING equipment

'Engineering end to end Greasing Solutions'
A host of new grease guns & pumps suited
to every possible application!

NEW PRODUCTS to look out for

- 12 LEVER OIL GUN
- 13 LEVER GREASE GUN - JAPANESE STYLE
- 14 DOUBLE LEVER GREASE GUN
- 17 DUAL DISCHARGE PISTOL GRIP GREASE GUN
- 18 ULTIMATE ALL WEATHER PISTOL GRIP GREASE GUN
- 22 QUICK CONNECT PISTOL GRIP GREASE GUN
- 24 CLEAR TUBE LEVER GREASE GUNS
- 25 CLEAR TUBE PISTOL GRIP GREASE GUNS
- 26 MINI LEVER GREASE GUN
- 31 BATTERY OPERATED GREASE GUN
- 33 HYDRAULIC COUPLER - PROFESSIONAL - SLIM
- 45 GREASE GUN LIGHT
- 48 GREASE FEEDERS
- 54 GREASING ADAPTORS & ELBOWS
- 66 GREASE CONTROL VALVES - METERED
- 68 FOOT OPERATED PUMP



01

LEVER GREASE GUNS - HEAVY DUTY



AUTOMOTIVE



INDUSTRIAL



AGRICULTURE

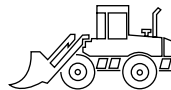

CONSTRUCTION

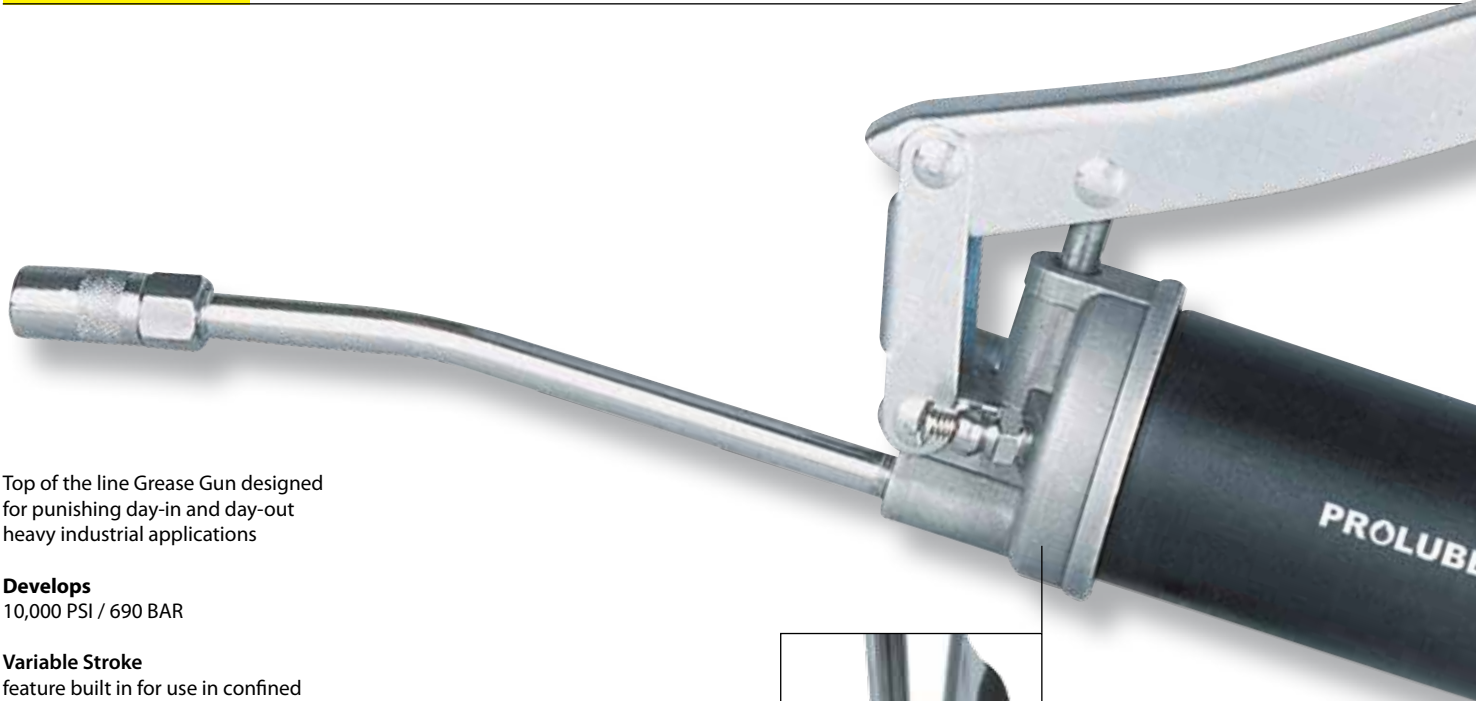

Top of the line Grease Gun designed for punishing day-in and day-out heavy industrial applications

Develops

10,000 PSI / 690 BAR

Variable Stroke

feature built in for use in confined areas

High Tolerance Aluminum Die Cast Grease Gun Head

Built Tough

Robust barrel 0.049 (1.2 mm) thick, Heavy Duty follower spring, CNC machined grease gun head, large rolled threads for fast & easy re-loading

Complete with a choice of 6" (150 mm) steel extension or 12" (300 mm) flexible hose & professional 4 jaw coupler with ball check



Heavy Duty Grease Gun Head incorporates a bulk loader and an air bleeder valve



427-80

For use with 450 gms grease cartridge, popular in Australia & New Zealand

Ø 63.5 mm



427-50

High Capacity Grease Gun for use with 24 oz. (750 cc) bulk grease or with standard 14 oz. (400 gms) grease cartridge

Ø 2-1/4" (57.15 mm)

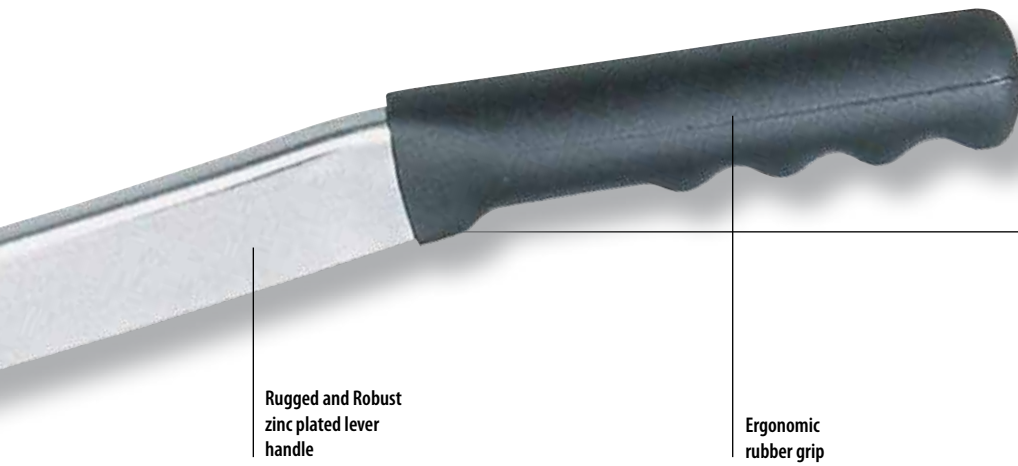

Rugged and Robust
zinc plated lever
handle

Ergonomic
rubber grip

DELIVERS

Upto 1gm / stroke
Upto 1 oz. / 28 strokes

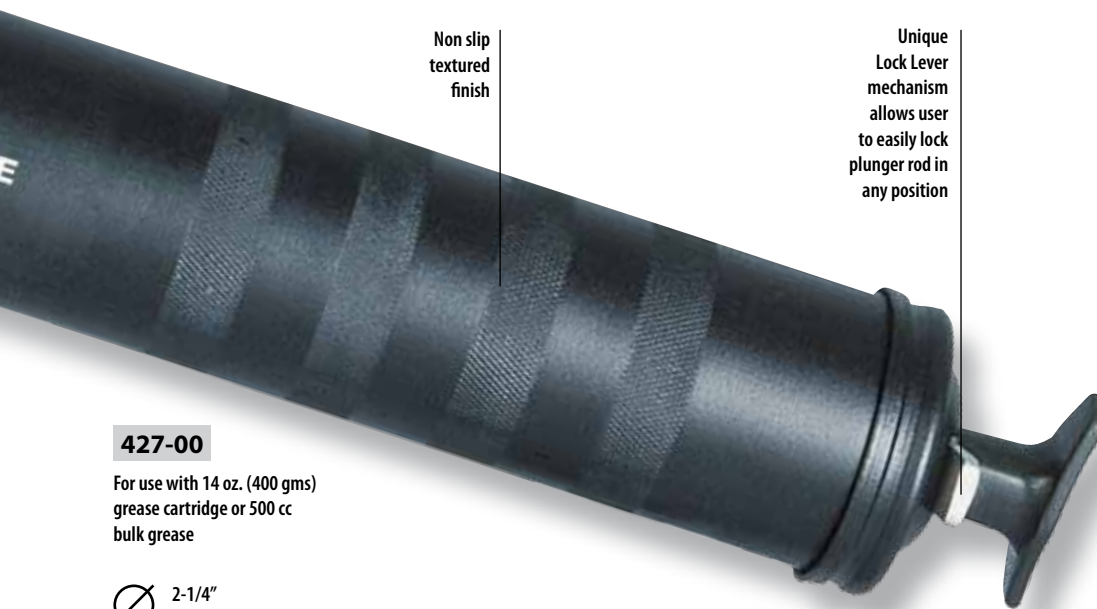

Non slip
textured
finish

Unique
Lock Lever
mechanism
allows user
to easily lock
plunger rod in
any position

427-00

For use with 14 oz. (400 gms)
grease cartridge or 500 cc
bulk grease

2-1/4"
(57.15 mm)



10,000 PSI
(690 BAR)

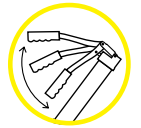

VARIABLE
STROKE

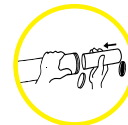

CARTRIDGE
LOADING

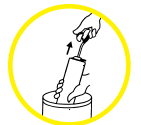

SUCTION
FILL

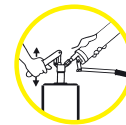

FILLER PUMP
LOADING



NO FALSE
LUBRICATION

PART NR.	PART NR. WITH FLEXIBLE HOSE & COUPLER	CARTRIDGE CAPACITY	BULK CAPACITY	THREADS
* 427-00	427-20	14 oz. (400gms)	500 cm ³	1/8" BSPT
* 427-01	427-21	14 oz. (400gms)	500 cm ³	M10 X 1
* 427-02	427-22	14 oz. (400gms)	500 cm ³	1/8" NPT
* 427-80	427-85	450 gms	650 cm ³	1/8" BSPT
427-50	427-60	14 oz. (400gms)	750 cm ³	1/8" BSPT
427-51	427-61	14 oz. (400gms)	750 cm ³	M10 X 1
427-52	427-62	14 oz. (400gms)	750 cm ³	1/8" NPT

Key * Best Seller



Grease Gun
can be custom
manufactured with
zinc head for use in
underground mines

02

LEVER GREASE GUN -
PROFESSIONAL



AUTOMOTIVE

Professional Grease Gun,
ideal for use in automotive
applications

Develops
8,000 PSI / 550 BAR

Variable Stroke
feature built in for use in
confined areas

Built Tough
Robust barrel 0.049" (1.2 mm)
thick, Heavy Duty Follower
Spring, CNC machined
grease gun head, large
rolled threads for fast & easy
re-loading

Capacity
14 oz. (400 gms) grease
cartridge or 500cc bulk fill

Complete with a choice of
6" (150 mm) steel extension
or 12" (300 mm) flexible
hose & professional 4 jaw
coupler with ball check



DELIVERS

Upto 1gm / stroke
Upto 1 oz. / 28 strokes

PART NR.	PART NR.	THREADS
WITH STEEL EXTENSION & COUPLER	WITH FLEXIBLE HOSE & COUPLER	
426-00	426-20	1/8" BSPT
426-01	* 426-21	M10 x 1
426-02	426-22	1/8" NPT

Key * Best Seller

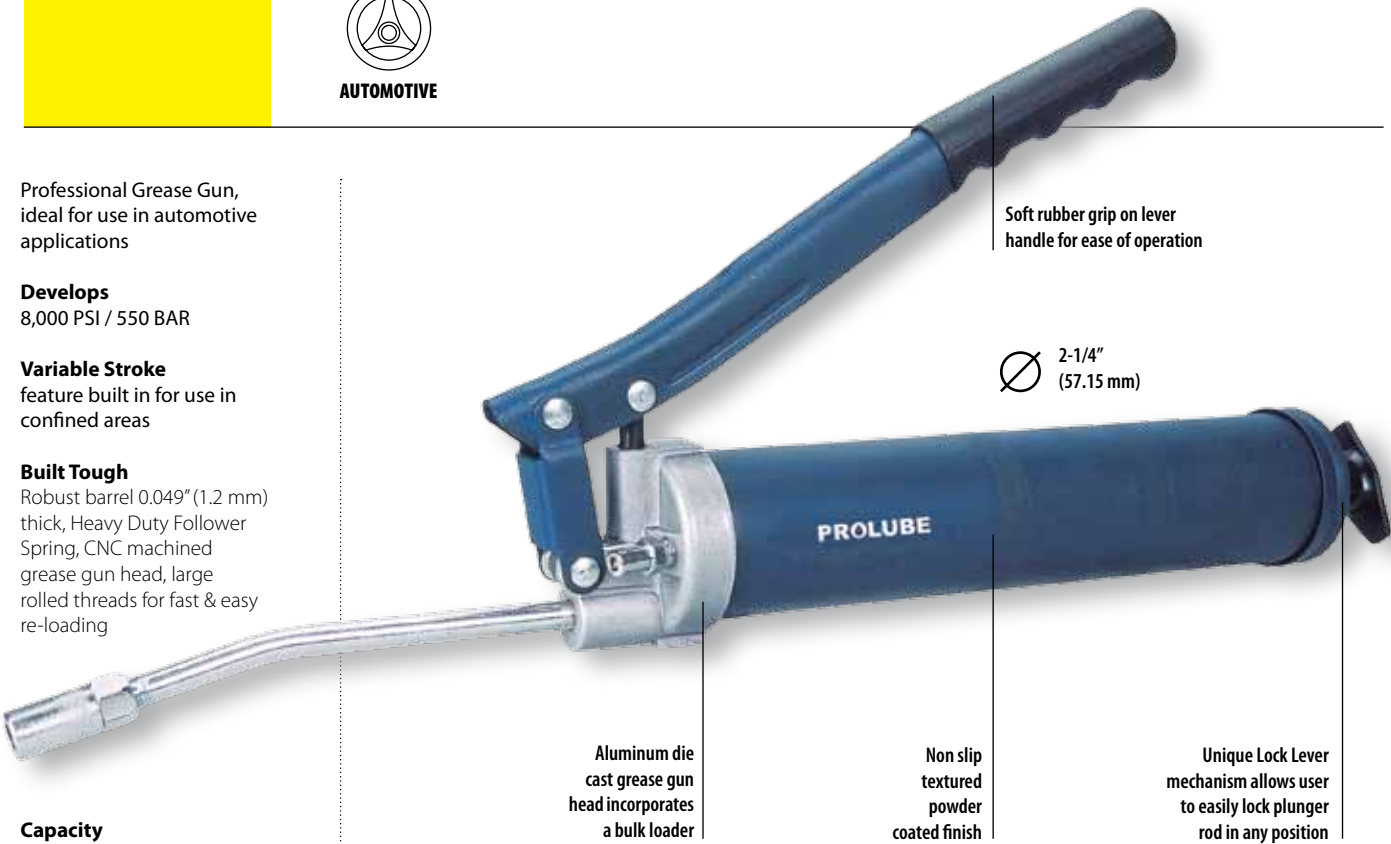

8,000 PSI
(550 BAR)

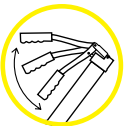

VARIABLE
STROKE

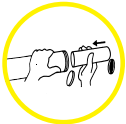

CARTRIDGE
LOADING



SUCTION
FILL

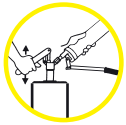

FILLER PUMP
LOADING



NO FALSE
LUBRICATION

03

LEVER GREASE GUNS - SUPER VALUE



AUTOMOTIVE



DIY



AGRICULTURE



MINING

By far the most popular grease gun for general purpose

Lubrication in automotive, workshop, agricultural & light industrial applications

Drop resistant steel head construction

Develops

6,000 PSI / 413 BAR

Air release either through loader fitting on the grease gun head or half turn of the head assembly

Soft rubber grip on lever handle for comfortable operation

Durable powder coated finish

Complete with a choice of 6" (150 mm) steel extension or 12" (300 mm) flexible hose & standard 4 jaw coupler with ball check

DELIVERS

Upto 1gm / stroke

Upto 1 oz. / 28 strokes



425-00

For use with 14 oz. (400 gms) grease cartridge or 500-cc bulk grease

Ø 2-1/4" (57.15 mm)

425-80

For use with 450 gms grease cartridge, popular in Australia & New Zealand

425-95

High Capacity Grease Gun for use with 24 oz. (750 cc) bulk grease or with standard 14 oz. (400 gms) grease cartridge

425-65

Extra Long & Very High Capacity Grease Gun for use with 1000 cc bulk grease or standard 14 oz. (400 gms) grease cartridge



Ø 63.5 mm



Ø 2-1/4" (57.15 mm)



Ø 2-1/4" (57.15 mm)

PART NR.	PART NR.	CARTRIDGE CAPACITY	BULK CAPACITY	THREADS
WITH STEEL EXTENSION & COUPLER	WITH FLEXIBLE HOSE & COUPLER			
* 425-00	425-20	14 oz. (400gms)	500 cm ³	1/8" BSPT
425-01	425-21	14 oz. (400gms)	500 cm ³	M10 X 1
425-02	425-22	14 oz. (400gms)	500 cm ³	1/8" NPT
* 425-80	425-85	450 gms	650 cm ³	1/8" BSPT
425-90	425-95	14 oz. (400gms)	750 cm ³	1/8" BSPT
425-91	425-96	14 oz. (400gms)	750 cm ³	M10 X 1
425-60	425-65	14 oz. (400gms)	1000 cm ³	1/8" BSPT
425-61	425-66	14 oz. (400gms)	1000 cm ³	M10 X 1

Key * Best Seller



6,000 PSI
(413 BAR)

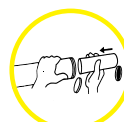

CARTRIDGE
LOADING



SUCTION
FILL

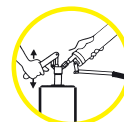

FILLER PUMP
LOADING

04

LEVER GREASE GUNS - STANDARD



AUTOMOTIVE

DIY

Hardworking entry level Grease Gun, designed for use in general lubrication and daily maintenance work

Head incorporates single vent hole with block nut

Develops

6,000 PSI / 413 BAR

Air release achieved through half turn of the head assembly

Durable powder coated finish

Capacity

14 oz (400 gms) grease cartridge or 500 cc bulk fill

Complete with a choice of 6" (150 mm) steel extension or 12" (300 mm) flexible hose & 4 jaw coupler with ball check



DELIVERS

Upto 1gm / stroke
Upto 1 oz. / 28 strokes



424-00

For use with 14 oz. (400 gms) grease cartridge or 500 cc bulk grease. Powder Coated Steel Head

2-1/4" (57.15 mm)



424-50

For use with 14 oz. (400 gms) grease cartridge or 500 cc bulk grease. Aluminum Die Cast Head

2-1/4" (57.15 mm)



424-30

For use with 14 oz. (400 gms) grease cartridge or 500 cc bulk grease. Powder coated Aluminum Die Cast Head & Heavy Duty Lever handle

2-1/4" (57.15 mm)

PART NR.	PART NR.	THREADS
WITH STEEL EXTENSION & COUPLER	WITH FLEXIBLE HOSE & COUPLER	
Steel Head		
424-00	424-20	1/8" BSPT
424-01	424-21	M10 x 1
* 424-02	424-22	1/8" NPT
Aluminum Die Cast Head		
424-50	424-70	1/8" BSPT
* 424-51	424-71	M10 x 1
* 424-52	424-72	1/8" NPT
Powder Coated Aluminum Die Cast Head		
424-30	424-40	1/8" BSPT
424-31	424-41	M10 x 1
* 424-32	424-42	1/8" NPT

Key * Best Seller



6,000 PSI (413 BAR)

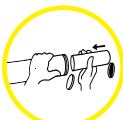

CARTRIDGE LOADING



SUCTION FILL

05



LEVER GREASE GUN - 'V' SERIES

DIY

21st Century design – Ideal combination of superior quality & value price

Aluminum Die Cast head fitted with air release valve

Soft rubber grip on lever handle for comfortable operation

Develops
6,000 PSI / 413 BAR

Capacity
14 oz (400 gms) grease cartridge or 500 cc bulk fill

Complete with a choice of 6" (150 mm) steel extension or 12" (300 mm) flexible hose & standard 4 jaw coupler with ball check

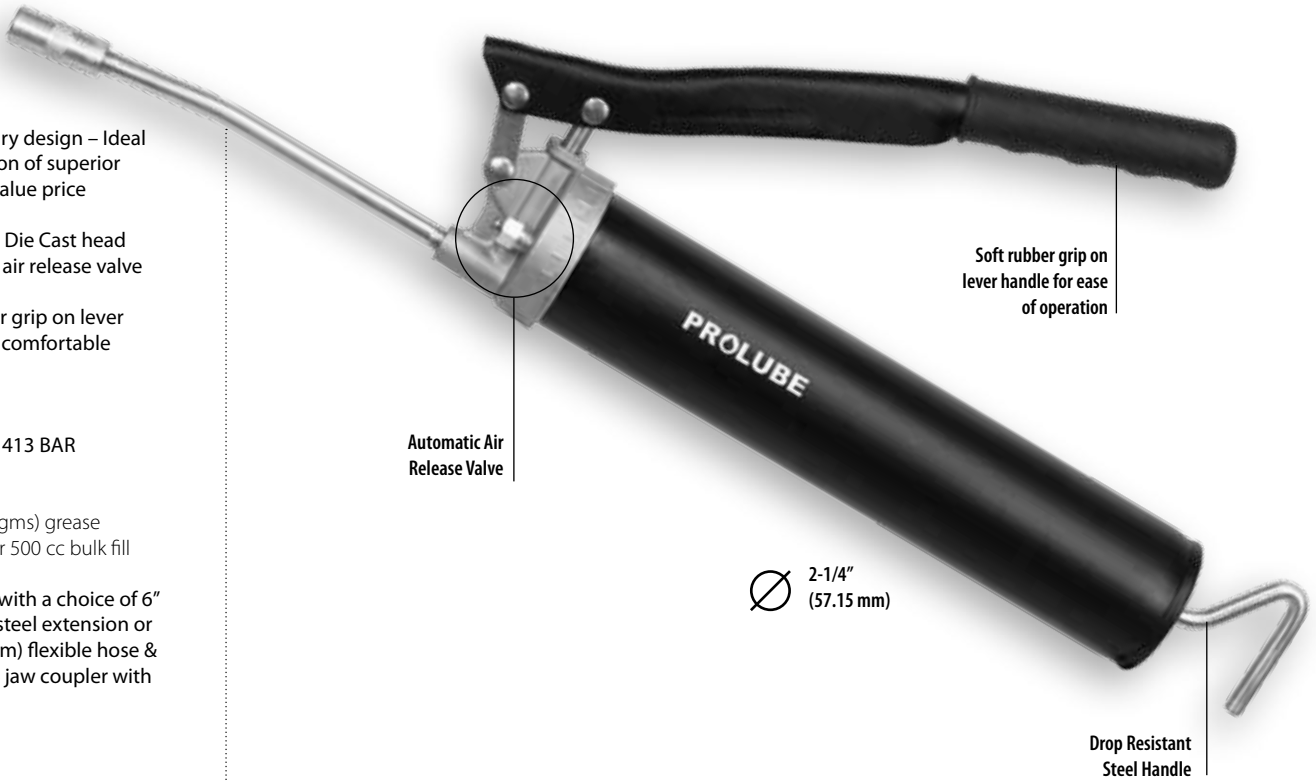

DELIVERS

Upto 1gm / stroke
Upto 1 oz. / 28 strokes

PART NR.	PART NR.	THREADS
WITH STEEL EXTENSION & COUPLER	WITH FLEXIBLE HOSE & COUPLER	
* 429-10	429-23	1/8" BSPT
* 429-15	429-24	M10 x 1
429-16	429-25	1/8" NPT

Key * Best Seller



6,000 PSI
(413 BAR)

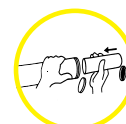

CARTRIDGE
LOADING

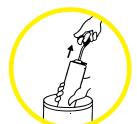

SUCTION
FILL

06

LEVER OIL GUN



Heavy Duty Oil Gun handles flowable greases & light oils without leakage

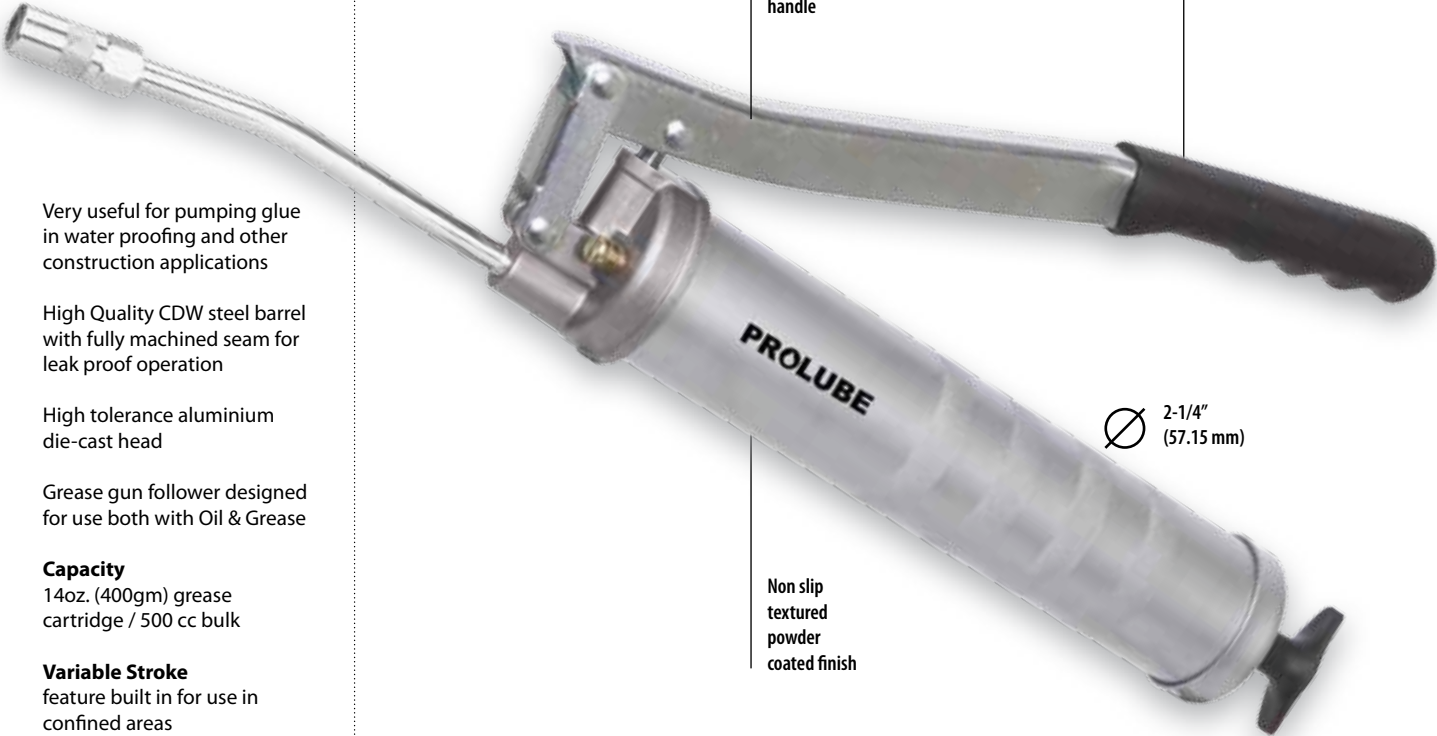

Rugged and robust zinc plated lever handle

Ergonomic rubber grip

2-1/4" (57.15 mm)

Non slip textured powder coated finish

Very useful for pumping glue in water proofing and other construction applications

High Quality CDW steel barrel with fully machined seam for leak proof operation

High tolerance aluminium die-cast head

Grease gun follower designed for use both with Oil & Grease

Capacity

14oz. (400gm) grease cartridge / 500 cc bulk

Variable Stroke

feature built in for use in confined areas

Develops

Upto 10,000 PSI / 690 BAR

Complete with a choice of 6" (150 mm) steel extension or 12" (300 mm) flexible hose & professional 4 jaw coupler with ball check



DELIVERS

Upto 1gm / stroke
Upto 1 oz. / 28 strokes

PART NR.	PART NR.	THREADS
WITH STEEL EXTENSION & COUPLER	WITH FLEXIBLE HOSE & COUPLER	
427-40	427-45	1/8" BSPT
427-41	427-46	M10 X 1
427-42	427-47	1/8" NPT



10,000 PSI (690 BAR)

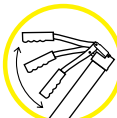

VARIABLE STROKE

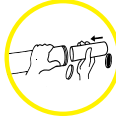

CARTRIDGE LOADING



Suitable for grease & oil



SUCTION FILL

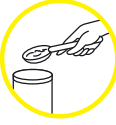

HAND FILL

07

LEVER GREASE GUN - JAPANESE STYLE



INDUSTRIAL



AGRICULTURE

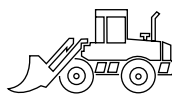

CONSTRUCTION

Professional Lever Grease Gun, ideal for use in Construction, Agricultural & Industrial applications

Develops

10,000 PSI / 690 BAR / 69 MPa

Built Tough

Robust Barrel 1.2 mm thick, Heavy Duty Follower Spring, Chain Style Follower Handle, large rolled threads for fast & easy re-loading

Precision CNC machined Die cast Aluminium Grease Gun Head with threaded port for use with Jiabara Style Grease Cartridges popular in Japan.

Capacity

400 gms grease cartridge or 600 cc bulk fill

Complete with 150 mm Steel Extension & professional Grease Coupler



DELIVERS

Upto 0.90 gms / stroke



Jiabara Grease Cartridge used with Lever Grease Gun - Japanese Style (not included)

Precision Machined Aluminium Die Cast Grease Gun Head (accepts Jiabara style grease cartridges threaded M15 x 2.5)

Non Slip Textured Powder coated finish

Ø 59.7 mm

Heavy Duty Chain for operating rubber follower



10,000 PSI
(690 BAR / 69 MPa)

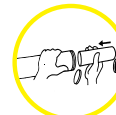

CARTRIDGE
LOADING

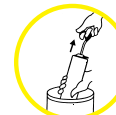

SUCTION
FILL



HAND
FILL

PART NR.	THREADS
427-90	1/8" BSPT

08

DOUBLE LEVER GREASE GUN



AUTOMOTIVE



INDUSTRIAL



WORKSHOP

Double lever grease gun for quick effortless High pressure greasing applications

Screw-in cartridge works on special "vacuum technology" that ensures full utilization of grease in the cartridge, as well as eliminates priming issues associated with conventional grease guns

Seal guards at the two ends of the cartridge create vacuum that pulls out grease thus emptying the cartridge completely

Robust high tolerance aluminum die cast head

Minimal wearing parts give it a long life

Protective cap for hose storage when not in use, prevents contamination at the hose end

No connections hence no potential leaks or occurrence of contamination

Delivers

Upto 0.80 gm / stroke
(1 oz. per 35 strokes)

Complete with 12" (300 mm) high pressure flexible hose with 4 jaw coupler

DELIVERS

Upto 0.8 gm / stroke
Upto 1 oz. / 35 strokes

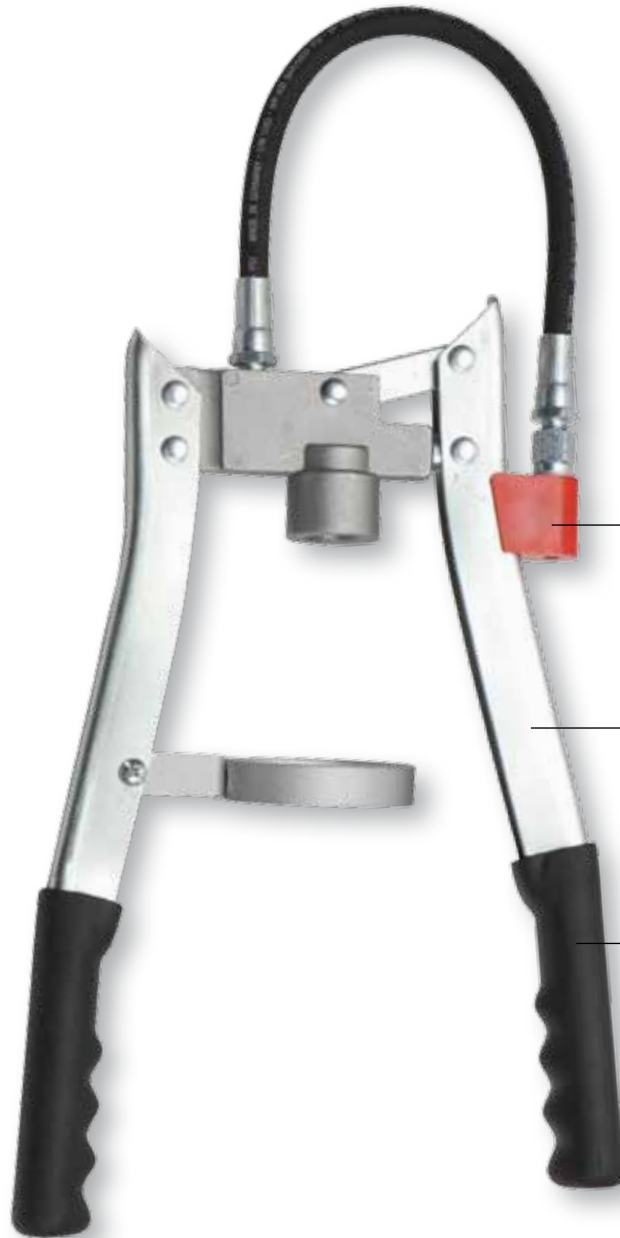

Protective cap to prevent contamination at the hose end

Rugged & robust zinc plated lever handle

Ergonomic rubber grip for convenience in use



7,500 PSI
(517 BAR)

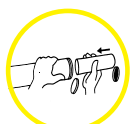

CARTRIDGE
LOADING

PART NR.	THREADS
427-95	1/8"BSPT
427-96	M10 X 1

09

PISTOL GRIP GREASE GUN - PROFESSIONAL



AUTOMOTIVE



INDUSTRIAL



CONSTRUCTION



AGRICULTURE

Lifetime product, ideal for frequent greasing applications

Patented feather touch design for minimal effort

Most useful for greasing in confined spaces or where access to grease fitting is restricted

Incorporates a unique variable stroke feature, not common with Pistol Grease guns. This allows the gun to reach increased greasing pressures from short strokes & high greasing volumes from full strokes

Machined to very close tolerances with perfect fits

Built Tough

Robust barrel 0.049" (1.2 mm) thick, Heavy Duty Follower Spring, CNC machined grease gun head, large rolled threads for fast & easy re-loading

Capacity

14 oz. (400 gms) grease cartridge or 500 cc bulk fill

Delivers

1.1/2 times more grease per stroke & at the same time generating pressures upto 7,500 PSI (517 BAR)

Complete with 9" (225 mm) high pressure flexible hose & professional 4 jaw coupler with ball check

Head incorporates a unique bulk loader, which doubles as an air bleeder

One piece aluminum die cast head & fixed handle offers extra strength & convenience in use

Designed for highest convenience in use with one hand operation & minimum effort that any gun can offer

Non slip textured finish

2-1/4" (57.15 mm)

Unique Lock Lever mechanism allows user to easily lock plunger rod in any position

DELIVERS

Upto 0.68 gm / stroke
Upto 1 oz. / 40 strokes

PART NR.	THREADS
* 430-61	1/8" BSPT
430-62	M10 x 1
* 430-63	1/8" NPT

Key * Best Seller

Grease Gun can be custom manufactured with zinc head for use in underground mines



7,500 PSI (517 BAR)

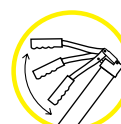

VARIABLE STROKE



NO FALSE LUBRICATION

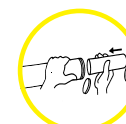

CARTRIDGE LOADING



SUCTION FILL



FILLER PUMP LOADING

10

'VARIO' PREMIUM
PISTOL GRIP GREASE GUNS



AUTOMOTIVE



INDUSTRIAL

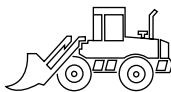

CONSTRUCTION



AGRICULTURE

Ergonomic One hand
Operation Grease Gun

**Unique Adjustable
Stroke Mechanism**
for both High
Volume & High
Pressure applications.
High volume for
faster greasing & High
pressure for use in cold
weather

Change in stroke achieved
through simple press
of the movable
handle

Solid 0.43" (11 mm) dia.
Piston for more grease
discharge per stroke

Drop Resistant Pistol
Assembly

Robust Aluminum Die cast
Grease Gun Head with
bulk filler

Rolled cylinder threads
offer maximum strength

**Handles NLGI 1, 2 & 3
grease**

Complete with 12"
(300 mm) high
pressure flexible hose
& professional 4 jaw
coupler with ball check

**UNIQUE ADJUSTABLE MECHANISM
HIGH PRESSURE / HIGH VOLUME**
High Pressure for use in cold weather
High volume for faster greasing

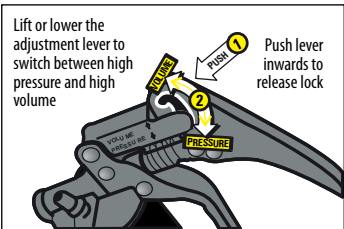

Bulk Loader
Valve

430-95

For use with 14 oz.
(400 gms) grease
cartridge or 500 cc
bulk grease

2-1/4"
(57.15 mm)

430-99

For use with 450 gms
grease cartridge,
popular in Australia
& New Zealand

2-1/4"
(57.15 mm)

DELIVERS

Upto 0.84 gms / stroke
Upto 1 oz. / 36 strokes

PART NR.	CARTRIDGE CAPACITY	BULK CAPACITY	THREADS
430-95	14 oz. (400 gms)	500 cm ³	1/8" BSPT
430-96	14 oz. (400 gms)	500 cm ³	M10 x 1
430-98	14 oz. (400 gms)	500 cm ³	M10 x 1
430-99	450 gms	650 cm ³	1/8" BSPT



7,000 PSI
(480 BAR)

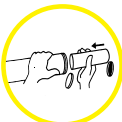

CARTRIDGE
LOADING

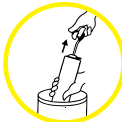

SUCTION
FILL

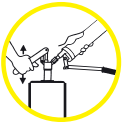

FILLER PUMP
LOADING

11

DUAL DISCHARGE PISTOL GRIP GREASE GUN



AUTOMOTIVE



AGRICULTURE



INDUSTRIAL

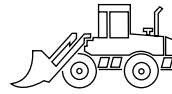

CONSTRUCTION

One Hand Operation with
a choice of front & top
discharge ports

Dual Ports

Make greasing easier
especially on grease fittings
with limited access

Heavy duty aluminium die
cast head with super strong
pistol handle

Plated finish on the Grease
Gun barrel makes it easy to
find / locate guns left in the
farm or under a tractor

Pistol handle designed
to prevent fingers from
"pinching"

Develops

Upto 5,000 PSI / 345 BAR

2 Way Loading

14 oz. cartridge or Suction Fill

Complete with 12" (300 mm)
flexible hose, 4" (100 mm)
steel extension & professional
4 jaw grease coupler



Front Port



Top Port

DELIVERS

Upto 0.50 gms / stroke
Upto 0.70 oz. / 40 strokes

PART NR.	CARTRIDGE CAPACITY	BULK CAPACITY	THREADS
430-15	14 oz. (400 gms)	500 cm ³	1/8" BSPT
430-16	14 oz. (400 gms)	500 cm ³	M10 x 1
430-17	14 oz. (400 gms)	500 cm ³	1/8" BSPT



5,000 PSI
(345 BAR)

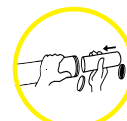

CARTRIDGE
LOADING

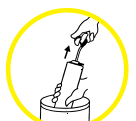

SUCTION
FILL

12

'ULTIMATE' ALL WEATHER PISTOL GRIP GREASE GUNS



AUTOMOTIVE



INDUSTRIAL

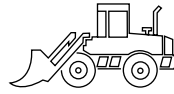

CONSTRUCTION



AGRICULTURE

All weather grease gun, designed especially for ease of use in very cold weather conditions

Venturi Mechanism coupled with a large grease inlet helps retain prime

Built tough

Robust grease gun barrel 0.049" (1.2 mm) thick, heavy duty follower spring, CNC machined grease gun head machined to very close tolerances that ensures perfect fits, large rolled threads for fast & easy re-loading

Double lipped rubber follower for use with 14 oz. (400 gms) grease cartridge / bulk, without any changeover

Heavy Duty plunger spring design keeps grease compressed, free of air pockets

Drop resistant Pistol Grip design

Also available with **Unique Adjustable Stroke Mechanism** that switches between high volume & high pressure applications with ease

High volume for faster greasing and high pressure for use in cold weather

Works with all grease types NLGI 1, 2 & 3

Develops

Upto 7,000 PSI / 483 BAR

Head incorporates a unique bulk loader, which doubles as an Air Bleeder

Compression Spring

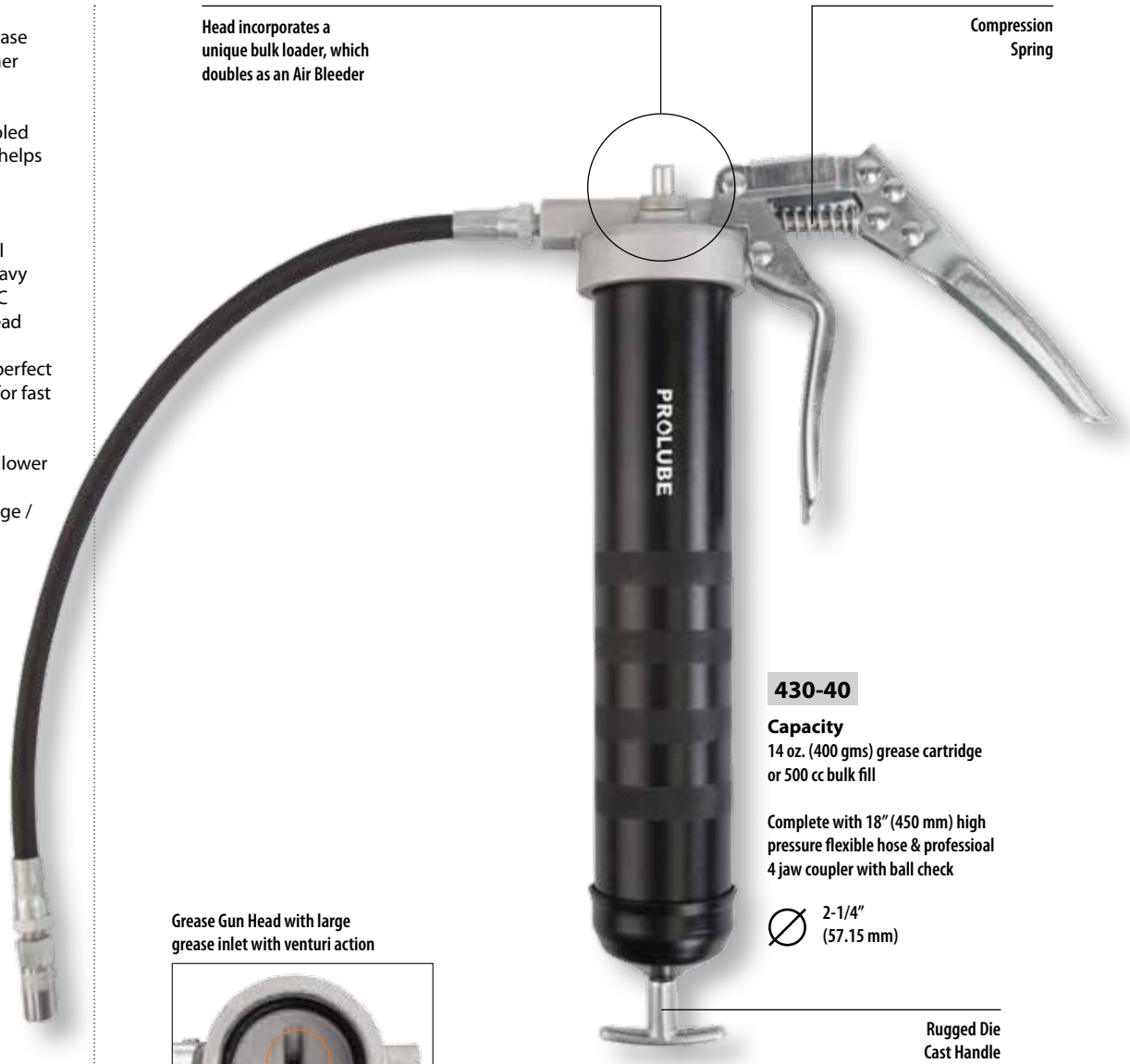

430-40

Capacity

14 oz. (400 gms) grease cartridge or 500 cc bulk fill

Complete with 18" (450 mm) high pressure flexible hose & professional 4 jaw coupler with ball check

2-1/4" (57.15 mm)

Rugged Die Cast Handle

Grease Gun Head with large grease inlet with venturi action



Premium Double Lipped Grease Follower for use with 14 oz. (400 gms) grease cartridge



DELIVERS

FOR G70

Upto 0.68 gm / stroke
Upto 1 oz. / 40 strokes

FOR G80 & G85

Upto 0.90 gm / stroke
Upto 1.30 oz. / 40 strokes

UNIQUE ADJUSTABLE MECHANISM
HIGH PRESSURE / HIGH VOLUME

High Pressure for use in cold weather
 High volume for faster greasing

Lift or lower the adjustment lever to switch between high pressure and high volume

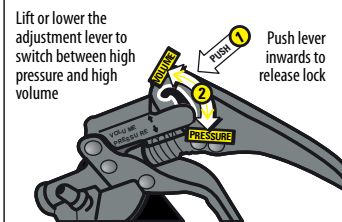

Head incorporates a unique bulk loader which doubles as an air bleeder

430-48
Capacity

450 gms grease cartridge

Complete with 12" (300 mm) high pressure flexible hose & professional 4 jaw coupler with ball check

63.5 mm

430-45
Capacity

14 oz. (400 gms) grease cartridge or 500 cc bulk fill

Complete with 12" (300 mm) high pressure flexible hose & professional 4 jaw coupler with ball check

2-1/4" (57.15 mm)

PART NR.	CARTRIDGE CAPACITY	BULK CAPACITY	THREADS
430-40	14 oz. (400gms)	500 cm ³	1/8" BSPT
430-41	14 oz. (400gms)	500 cm ³	M10 x 1
* 430-42	14 oz. (400gms)	500 cm ³	1/8" NPT

PART NR.	CARTRIDGE CAPACITY	BULK CAPACITY	THREADS
430-45	14 oz. (400gms)	500 cm ³	1/8" BSPT
430-46	14 oz. (400gms)	500 cm ³	M10 X 1
430-47	14 oz. (400gms)	500 cm ³	1/8" NPT
430-48	450 gms	650 cm ³	1/8" BSPT

Key * Best Seller



7,000 PSI
(483 BAR)

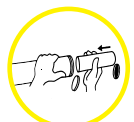

CARTRIDGE
LOADING

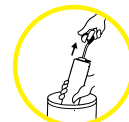

SUCTION
FILL

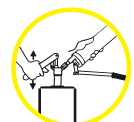

FILLER PUMP
LOADING

13

PISTOL GRIP GREASE GUNS



AUTOMOTIVE



INDUSTRIAL

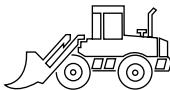

CONSTRUCTION

Most popular One Hand Operated Grease Gun designed for use in confined spaces or where access to grease nipple is restricted

Built Tough

Robust barrel 0.049" (1.2 mm) thick, Heavy Duty Follower Spring, CNC machined grease gun head, large rolled threads for fast & easy re-loading

Heavy Duty Aluminum Die Cast Head & super strong pistol grip handle

Pistol Handle designed to prevent fingers from "Pinching"

Develops

5,000 PSI / 345 BAR

Complete with a choice of 4" (100 mm) steel extension or 12" (300 mm) flexible hose & professional 4 jaw coupler with ball check



Grease Gun can be custom manufactured with zinc head for use in underground mines

DELIVERS

Upto 0.50 gm / stroke
Upto 0.70 OZ. / 40 strokes

430-85

For use with 450 gms grease cartridge, popular in Australia & New Zealand. Head fitted with steel block nut

63.5 mm

430-70

For use with 14 oz. (400 gms) grease cartridge or 500 cc bulk. Head fitted with bulk loader & air release valve. Comfortable vinyl grip on movable handle

2-1/4" (57.15 mm)

430-00

For use with 14 oz. (400 gms) grease cartridge or 500 cc bulk

2-1/4" (57.15 mm)

PART NR. WITH STEEL EXTENSION & COUPLER	PART NR. WITH FLEXIBLE HOSE & COUPLER	CARTRIDGE CAPACITY	BULK CAPACITY	THREADS
430-00	430-20	14 oz (400 gms)	500cm ³	1/8" BSPT
430-01	430-21	14 oz (400 gms)	500cm ³	M10 x 1
* 430-02	* 430-22	14 oz (400 gms)	500cm ³	1/8" NPT
* 430-80	* 430-85	450 gms	650cm ³	1/8" BSPT
430-50	430-70	14 oz (400 gms)	500cm ³	1/8" BSPT
430-51	430-71	14 oz (400 gms)	500cm ³	M10 x 1
430-52	430-72	14 oz (400 gms)	500cm ³	1/8"NPT

Key * Best Seller

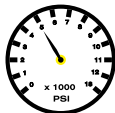

5,000 PSI
(345 BAR)

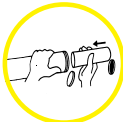

CARTRIDGE
LOADING

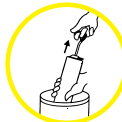

SUCTION
FILL

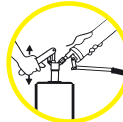

FILLER PUMP
LOADING
(ONLY G5-PRO)

14



PISTOL GRIP GREASE GUN - 'V' SERIES

DIY

Value Priced One Hand
Operated Pistol Grip Grease
Gun

Aluminium Die Cast head fitted
with air release valve

Develops
5,000 PSI / 345 BAR

Capacity
14 oz. (400 gms) grease cartridge
or 500 cc bulk

Complete with a choice of 4"
(100 mm) steel extension or
12" (300 mm) flexible hose &
standard 4 jaw coupler with
ball check

DELIVERS

Upto 0.50 gm / stroke
Upto 0.70 oz. / 40 strokes



For use with 14 oz.
(400 gms) grease
cartridge or 500 cc
bulk grease

Ø 2-1/4"
(57.15 mm)

Drop Resistant
Steel Handle



5,000 PSI
(345 BAR)

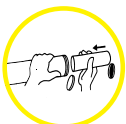

CARTRIDGE
LOADING

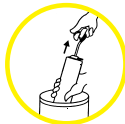

SUCTION
FILL

PART NR.	PART NR.	CARTRIDGE CAPACITY	BULK CAPACITY	THREADS
WITH STEEL EXTENSION & COUPLER	WITH FLEXIBLE HOSE & COUPLER			
429-53	429-73	14 oz (400 gms)	500cm ³	1/8" BSPT
429-54	429-74	14 oz (400 gms)	500cm ³	M10 x 1
429-55	429-75	14 oz (400 gms)	500cm ³	1/8" NPT

15

QUICK CONNECT PISTOL GRIP GREASE GUN



AUTOMOTIVE



INDUSTRIAL

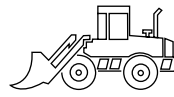

CONSTRUCTION



AGRICULTURE



Quick-Load Technology is a unique concept that allows for fast reloading process. Quick-Load features threadless quick connect barrel that significantly reduces downtime. Simply pull the Quick-Load switch to disengage the barrel. Never worry about crossing threads on your barrel again!

This grease gun rivals others in quality, function and pressure output while maintaining the convenience of one hand operation

Grease gun head fitted with bulk loader & automatic release valve. Automatic release valve bleeds out air when loading grease guns, without the need to manually operate the valve

Unique Adjustable Stroke Mechanism that switches between high volume & high pressure applications with ease

Grease inlet with venturi action helps retain prime

Double lipped rubber follower allows use with grease cartridge bulk without any change-over

Capacity
14 oz. (400 gms) grease cartridge or 500 cc bulk fill

Works with NLGI 1, 2 & 3 greases

Complete with 18" (450 mm) high pressure flexible hose & professional 4 jaw coupler.

DELIVERS

Upto 0.90 gm / stroke
Upto 1 oz. / 31 strokes

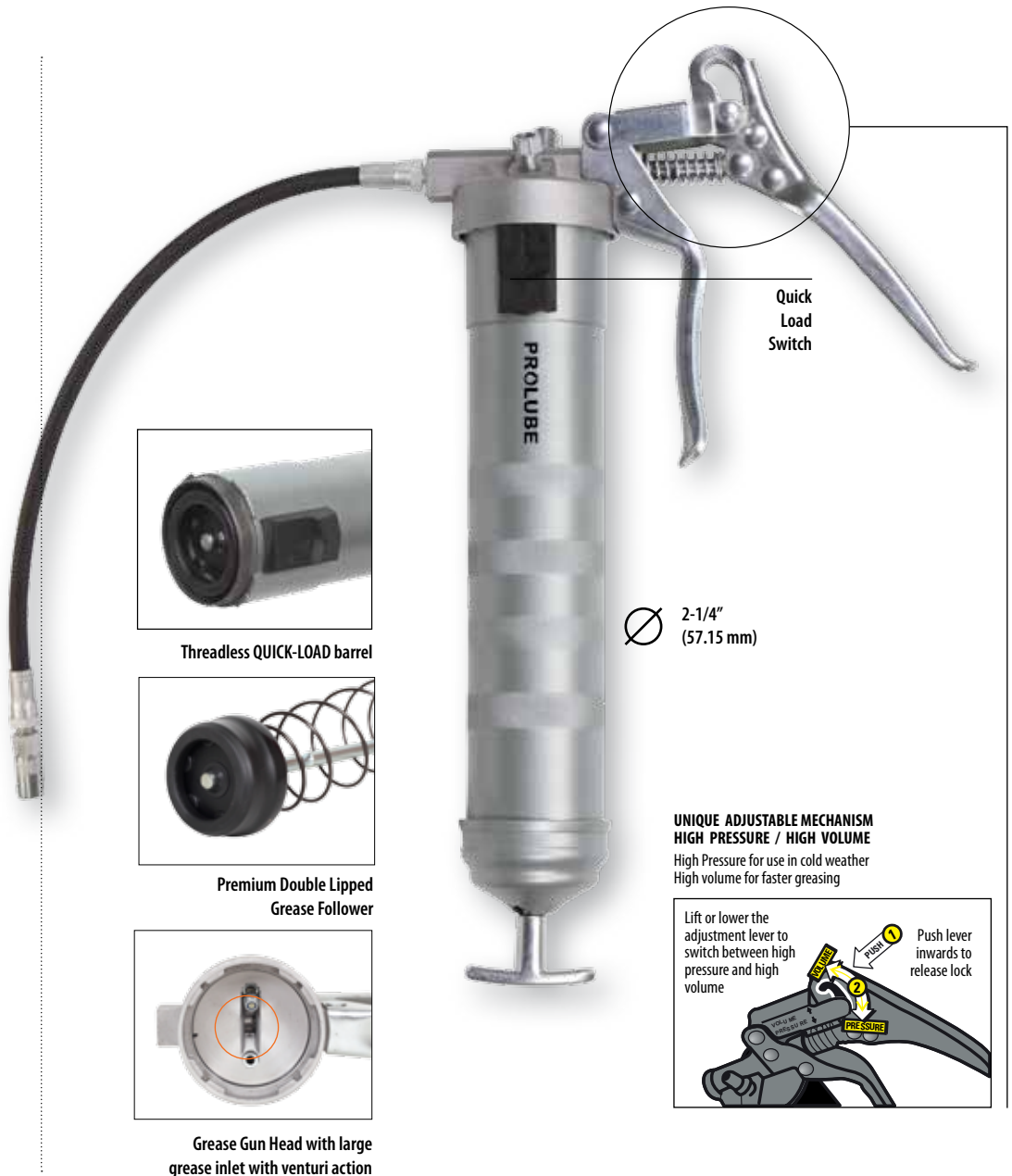

PART NR.	THREADS
430-43	1/8" BSPT
430-44	M10 X 1
430-49	1/8" NPT



7,000 PSI
(483 BAR)

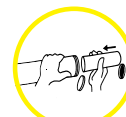

CARTRIDGE
LOADING



SUCTION
FILL

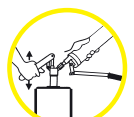

FILLER PUMP
LOADING

clear tube

A perfect addition to any lubrication program!!

- Proper identification of grease
- Eliminates cross-contamination
- Visibility of air pockets
- Visibility to remaining grease
- Eliminates risk of mixing greases

Clear tube equipment from PROLUBE makes you 100% sure of what you are dispensing; ensuring you don't make costly mistakes that cannot be reversed.

Different equipment, machines, bearings and vehicles require different types of lubricants. Proper identification of the lubricant once installed in the equipment can be challenging.

An estimated 60% of bearing failures all over the world are due to lubricant cross contamination. This leads to costly downtime & expensive machinery repairs.

Switch to '**Clear Tube Equipment**' for you have a simple & cost effective means to prevent this

These have applications everywhere, especially in Marine, Naval Aviation, Military, & Food Industry



Also available with colour coded end caps for colour coding based on grease type, frequency of use or application point



Clear Tube Lever Grease Guns	pg 24
Clear Tube Pistol Grip Grease Guns	pg 25
Clear Tube Lever Oil Pump	pg 78
Clear Tube Suction Gun	pg 110

16

CLEAR TUBE
LEVER GREASE GUNS



INDUSTRIAL



DEFENCE

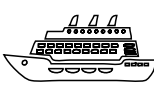

MARINE



FOOD

Unique concept & design that allows quick & clear lubricant identification, thus eliminating the risk of cross contamination or mixing of incompatible lubricants

Tough, impact resistant & drop resistant polycarbonate tube with Aluminium die cast head with bulk loader & air release valve

High tolerance Aluminium die cast head with bulk loader & air release valve

Variable stroke
for ease of use in confined spaces

Develops
10,000 PSI / 690 BAR

Available in a choice of 14oz. (400 gm) capacity or 450 gm capacity popular in Australia & New Zealand

Complete with 6" (150 mm) steel extension & professional 4 jaw coupler with ball check

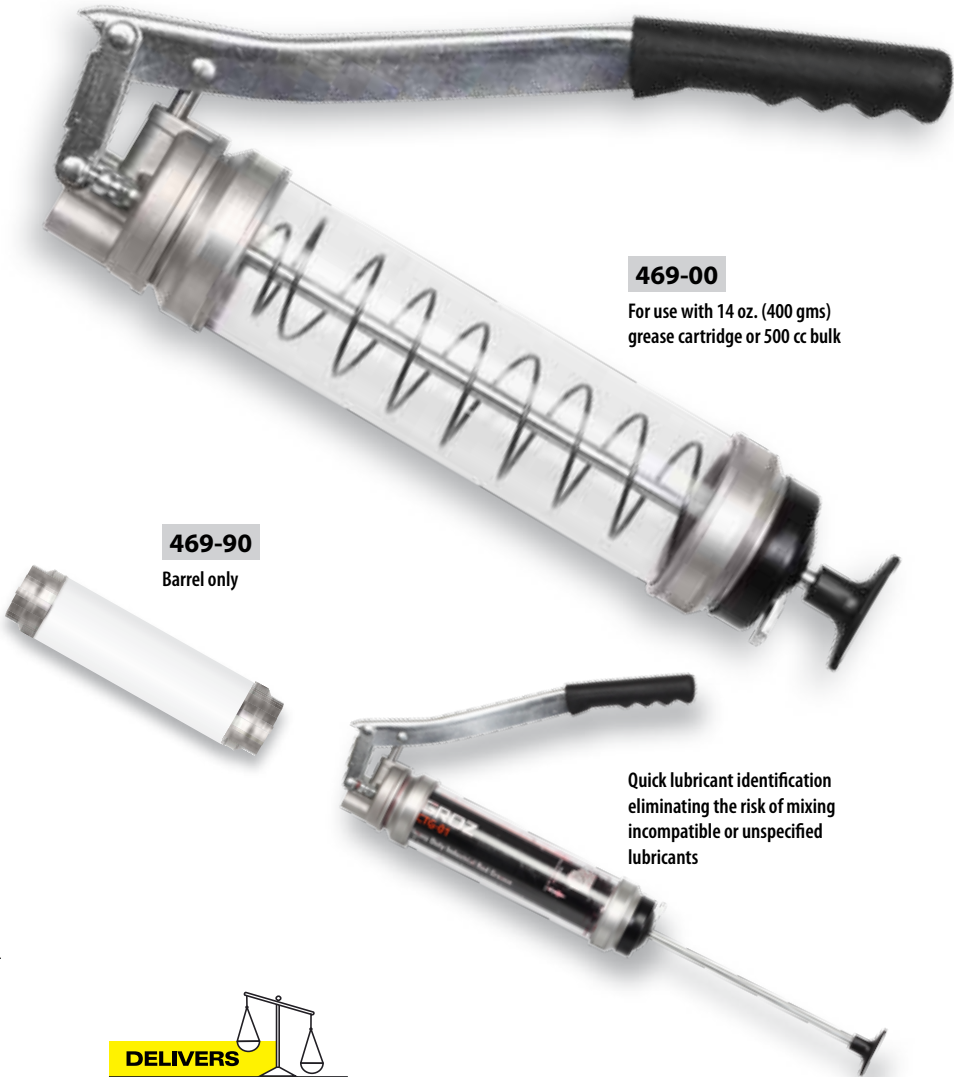

469-00
For use with 14 oz. (400 gms) grease cartridge or 500 cc bulk

469-90
Barrel only

Quick lubricant identification eliminating the risk of mixing incompatible or unspecified lubricants

! WARNING

Designed for use with grease only:
Do not use with: ESTER based Greases, Synthetic Greases such as Aeroshell 33 Grease, Aeroshell 7 Grease, Skydrol Products etc. These have an adverse effect on the clear polycarbonate tube & can cause fogging , cracking & fracturing of the tube.

DELIVERS

Upto 1 gm / stroke
Upto 1 oz. / 28 strokes

PART NR.	CARTRIDGE CAPACITY	BULK CAPACITY	THREADS
GREASE GUN			
469-00	14 oz. (400 gms.)	500 cm3	1/8" BSPT
469-01	14 oz. (400 gms.)	500 cm3	M10 X 1
469-02	14 oz. (400 gms.)	500 cm3	1/8" NPT
469-03	450 gms	650 cm3	1/8" BSPT
BARREL ONLY			
469-90	14 oz. (400 gms.) replacement for clear tube barrel only		2.2806" x 16 UNF
469-91	450 gms replacement for clear tube barrel only		2.5" x 16 UNF



10,000 PSI
(690 BAR)

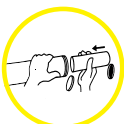

CARTRIDGE
LOADING

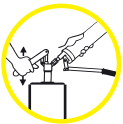

FILLER PUMP
LOADING

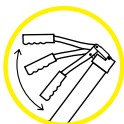

VARIABLE
STROKE

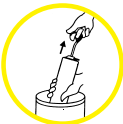

SUCTION
FILL

17

CLEAR TUBE PISTOL GRIP GREASE GUNS



INDUSTRIAL



DEFENCE

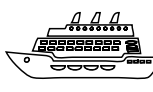

MARINE



FOOD

Unique concept & design that allows quick & clear lubricant identification, thus eliminating the risk of mixing of cross contamination or incompatible lubricants

Tough, impact resistant & drop resistant polycarbonate tube with Aluminium die cast adaptors

Heavy Duty Aluminum die cast head fitted with steel block nut

Develops

5,000 PSI / 345 BAR

Super strong pistol grip handle designed to prevent pinching of fingers

Available in choice of 14 oz. (400gm) capacity or 450 gm capacity popular in Australia & New Zealand

Complete with 4" (100 mm) steel extension, 12" (300 mm) flexible hose extension & professional 4 jaw coupler with ball check

DELIVERS

Upto 0.50 gm / stroke

Upto 0.70 oz. / 40 strokes



469-90

Barrel only



Quick lubricant identification eliminating the risk of mixing incompatible or unspecified lubricants



469-23

For use with 450 gm grease cartridge or 650 cc bulk

! WARNING

Designed for use with grease only:
Do not use with: ESTER based Greases, Synthetic Greases such as Aeroshell 33 Grease, Aeroshell 7 Grease, Skydrol Products etc. These have an adverse effect on the clear polycarbonate tube & can cause fogging, cracking & fracturing of the tube.



5,000 PSI
(345 BAR)

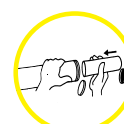

CARTRIDGE
LOADING

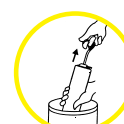

SUCTION
FILL

PART NR.	CARTRIDGE CAPACITY	BULK CAPACITY	THREADS
GREASE GUN			
469-20	14 oz. (400 gms.)	500 cm ³	1/8" BSPT
469-21	14 oz. (400 gms.)	500 cm ³	M10 X 1
469-22	14 oz. (400 gms.)	500 cm ³	1/8" NPT
469-23	450 gms	650 cm ³	1/8" BSPT
BARREL ONLY			
469-90	Replacement clear tube barrel only 14 oz. (400 gms)		2.2806" X 16 UNF
469-91	Replacement clear tube barrel only 450 gms		2.5" X 16 UNF

18

MINI LEVER GREASE GUN



AUTOMOTIVE



AGRICULTURE

DIY

Mini Lever Grease Gun with die cast grease gun head

Compact Tool Box Size

Develops upto 6,000 PSI / 413 BAR, the highest in its class of any mini grease gun

Capacity

3 oz (85 gms) grease cartridge or 120 cc bulk fill

Complete with 6" steel extension and 4 jaw coupler with ball check

DELIVERS

Upto 0.55 gm / stroke
Upto 0.80 oz. / 40 strokes



6,000 PSI
(413 BAR)

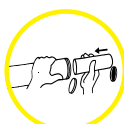

CARTRIDGE
LOADING

When you need a tough little grease gun for hard to get in places, that doesn't take up a lot of space, THIS IS IT!



PART NR.	THREADS
432-80	1/8" BSPT
432-81	M10 X 1
432-82	1/8" NPT

19

PUSH TYPE GREASE GUNS



INDUSTRIAL

DIY

Push type grease gun for use with bulk grease only

Compact toolbox size, ideal for greasing impact wrenches, lawn mowers, chain saws, trailers, ATV's, autos & trucks etc

Develops

1,000 PSI / 69 BAR

Comes complete with Universal connector

Can be custom built with Pointed nozzle for special applications

DELIVERS

Upto 0.90 gm / shot
Upto 1 oz. / 32 shots



1,000 PSI
(69 BAR)

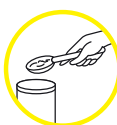

HAND
FILL



Align Push Gun straight with fitting

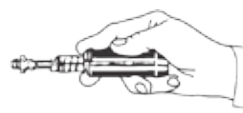

Push with palm of hand



431-01
Capacity
125 cc
capacity

PART NR.	BULK CAPACITY
* 431-00	30 cm ³
431-01	125 cm ³

Key * Best Seller

20

MINI PISTOL GREASE GUNS - DELUXE



AUTOMOTIVE

DIY

One hand Pistol grip grease gun with convenient pull type operating mechanism

Capacity

3 oz. (85 gms) grease cartridge

Available in a choice of black powder coated finish or textured zinc plated

Develops

3,500 PSI / 240 BAR

Complete with 4" steel extension and 4 jaw coupler with ball check

PART NR.	PART NR.	THREADS
POWDER COATED FINISH	ZINC PLATED FINISH	
432-50	432-60	1/8" BSPT
* 432-51	* 432-61	M10 x 1
432-52	432-62	1/8"NPT

Key * Best Seller



Front Discharge Port used for regular greasing applications

Top Port used primarily with flexible hose for greasing in inaccessible areas

1.42" (36 mm)



3,500 PSI (240 BAR)

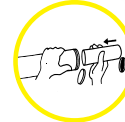

CARTRIDGE LOADING

DELIVERS

Upto 0.40 gm / stroke
Upto 0.60 oz. / 40 strokes

21

MINI PISTOL GREASE GUN - POPULAR

DIY

A low cost, compact tool box size grease gun, perfect for hard to reach jobs

One hand pistol grip grease gun with push type operating mechanism

Aluminum die cast head

Capacity

3 oz (85 gms) grease cartridge

PART NR.	THREADS
432-00	1/8" BSPT
432-01	M10 x 1
* 432-02	1/8"NPT

Key * Best Seller

Textured powdered coated finish for non-slip grip

Complete with 4" (100 mm) steel extension and 4 jaw coupler with ball check



3,000 PSI (207 BAR)

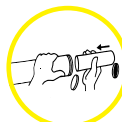

CARTRIDGE LOADING

DELIVERS

Upto 0.40 gm / stroke
Upto 0.60 oz. / 40 strokes



1.42" (36 mm)

22

AIR OPERATED GREASE GUNS



AUTOMOTIVE



INDUSTRIAL



CONSTRUCTION



AGRICULTURE

Ideal for use in factory maintenance, agricultural applications, fleet service or for use on trucks connected to vehicle air brake compressors

Air Operating Range

40–120 PSI (3-8 BAR)

Pressure Ratio

40:1

Air Compressor Volume

1 cfm / 0.026 cubic metre and above

Air Inlet Threaded

1/4" (F)

Each gun supplied with a male quick coupler fitting

Available in 2 versions

INTERMITTENT

Grease discharge with every press of trigger

AUTOMATIC

Continuous grease discharge with the trigger pressed

Complete with 6" (150 mm) steel extension or 12" (300 mm) flexible hose & professional 4 jaw coupler



Head casting fitted with bulk loader valve

DELIVERS



Upto 0.90 gm / shot
(1.30 oz. / 40 strokes for PGG)

Upto 400 gm / min
(14 oz. / min for AGG)



4,800 PSI
(330 BAR)



WARNING

Always use lubrication unit with Air Supply



433-80

Intermittent Action with grease discharge per shot. For use with 450 gms grease cartridge, popular in Australia & New Zealand

Ø 63.5 mm



433-03

Automatic Action with continuous grease discharge. For use with 14 oz. (400 gms) grease cartridge or 500 cc bulk grease

Ø 2-1/4" (57.15 mm)



433-81

Automatic Action with continuous grease discharge. For use with 450 gms grease cartridge, popular in Australia & New Zealand

Ø 63.5 mm

Heavy Duty aluminum
die cast head with
internal bore precision
honed for rapid action

Ergonomic pistol grip and
acute angle design allows
for ease of operation,
especially in narrow spaces

AIR INLET threaded
1/4" (F). Each gun
supplied with a male
quick coupler fitting

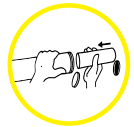

**CARTRIDGE
LOADING**

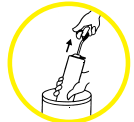

**SUCTION
FILL**

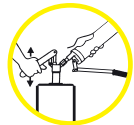

**FILLER PUMP
LOADING**

433-00

Intermittent Action
with grease discharge
per shot. For use with
14 oz. (400 gms) grease
cartridge or 500 cc bulk

Ø 2-1/4"
(57.15 mm)

PART NR. WITH STEEL EXTENSION & COUPLER	PART NR. WITH FLEXIBLE HOSE & COUPLER	CARTRIDGE CAPACITY	BULK CAPACITY	THREADS
433-00	433-20	14 oz (400 gms)	500cm ³	1/8" BSPT
433-01	433-21	14 oz (400 gms)	500cm ³	M10 x 1
* 433-02	433-22	14 oz (400 gms)	500cm ³	1/8" NPT
433-80	433-85	450 gms	650cm ³	1/8" BSPT
433-03	433-23	14 oz (400 gms)	500cm ³	1/8" BSPT
433-04	433-24	14 oz (400 gms)	500cm ³	M10 x 1
* 433-05	433-25	14 oz (400 gms)	500cm ³	1/8" NPT
433-81	433-89	450 gms	650cm ³	1/8" BSPT

Key * Best Seller



23

HIGH POWER AIR OPERATED GREASE GUN



AUTOMOTIVE



INDUSTRIAL

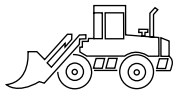

CONSTRUCTION

High power one shot air grease gun

Designed with grease cylinder on top for optimal balance

For use in factory maintenance, farm, fleet service or for use from vehicle air brake compressors

Air Operating Range
40–120 PSI (3–8 BAR)

Pressure Ratio
50:1

Air Compressor Volume
1 cfm / 0.026 cubic metre and above

For use with 14 oz (400 gms) grease cartridge or 500 cc bulk

Complete with 6" (150 mm) steel extension or 9" (225 mm) high pressure flexible hose & professional 4 jaw coupler

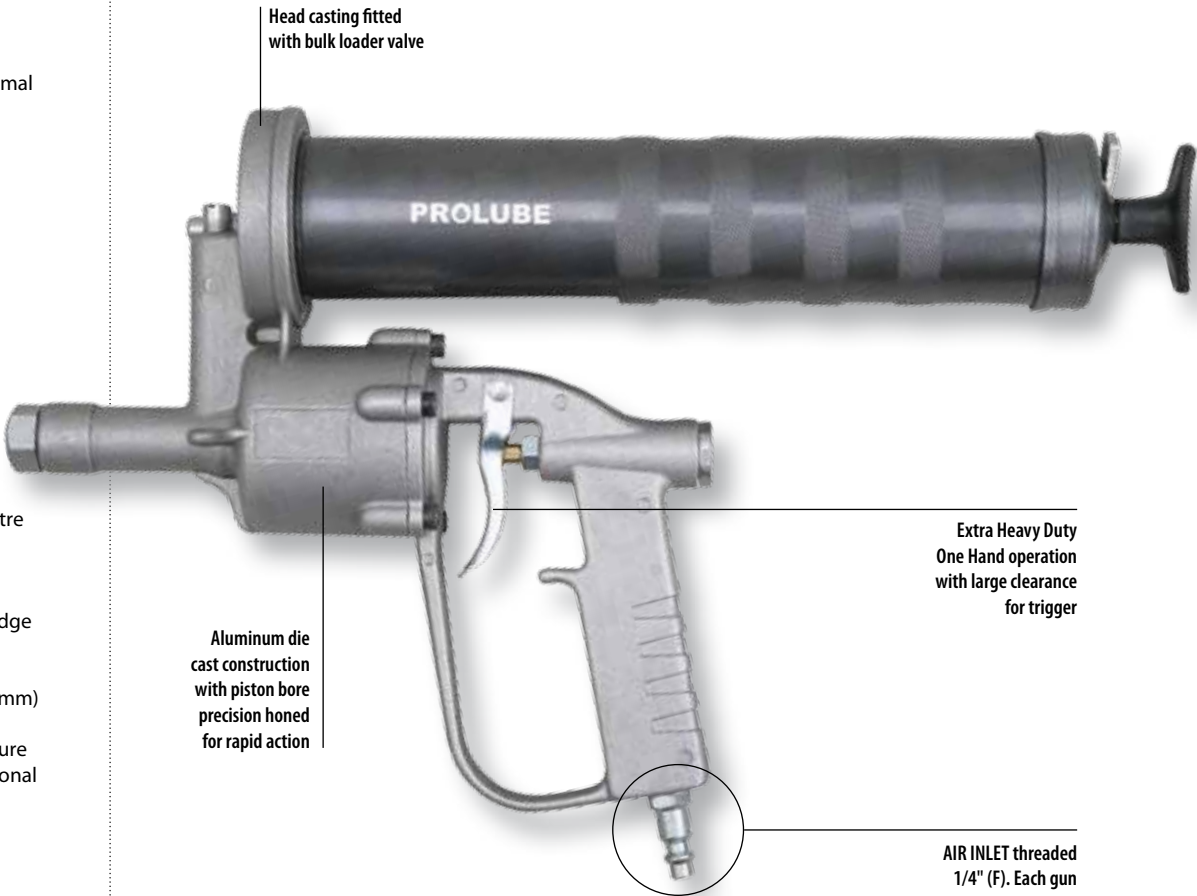

DELIVERS

0.68 gm / shot
1 oz. / 40 shots

! WARNING

Always use lubrication unit with Air Supply

PART NR.	PART NR.	THREADS
WITH STEEL EXTENSION & COUPLER	WITH HIGH PRESSURE FLEXIBLE HOSE & COUPLER	
* 433-60	433-70	1/8" BSPT
* 433-61	* 433-71	M10 x 1
433-62	* 433-72	1/8"NPT

Key * Best Seller

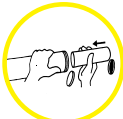

CARTRIDGE LOADING

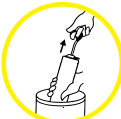

SUCTION FILL



6,000 PSI (413 BAR)

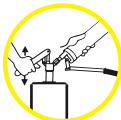

FILLER PUMP LOADING

24

19.2V BATTERY POWERED GREASE GUN



AUTOMOTIVE



INDUSTRIAL



CONSTRUCTION



AGRICULTURE

Powerful 19.2V High Torque Motor

Standard 1.5Ah Ni-Cd Battery Pack

An additional 1.5Ah Ni-Cd Battery Pack for uninterrupted greasing

Automatic air release valve and bulk loader

Develops
6,000 PSI / 413 BAR

One Hour Quick Charger (each battery charge provides power to dispense upto 6 grease cartridges in free flow condition)

Complete with 30" (760 mm) high pressure hose with spring guard on both ends (prevents hose from kinking) & high pressure 4 jaw grease coupler

Designed for use by mechanics, technicians, maintenance staff, farmers etc for everyday greasing and preventive maintenance jobs

Available in a choice of 14 oz. (400 gm) or 450 gm capacity, popular in Australia & New Zealand



Comes with Blow Moulded Case for conveniently storing when not in use

Shoulder Strap included

Safety Valve releases grease at pressures over 6,000 PSI, preventing damage to gun due to excessive back pressure

Automatic Air Release Valve



6,000 PSI
(413 BAR)

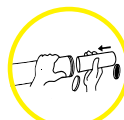

CARTRIDGE LOADING



SUCTION FILL



FILLER PUMP LOADING

PART NR.	DESCRIPTION
GREASE GUN ASSEMBLY	
472-00	14 oz. (400 gm) Grease Gun, 110V/60 Hz. Battery Charger with US Plug
472-01	14 oz. (400 gm) Grease Gun, 220V/50 Hz. Battery Charger with EU Plug
472-02	14 oz. (400 gm) Grease Gun, 220V/50 Hz. Battery Charger with UK Plug
472-03	450 gm Grease Gun, 220V/50 Hz. Battery Charger with AU Plug
SPARE PARTS & ACCESSORIES	
472-50	Rechargeable Battery, 19.2V, 1.5 Ah, Ni-Cd
472-51	1 hour cUL listed Battery Charger, 110V/60Hz, 19.2V, US Plug
472-52	1 hour CE Energy Saving Battery Charger, 220V/50Hz, 19.2V, EU Plug
472-53	1 hour CE Energy Saving Battery Charger, 220V/50Hz, 19.2V, UK Plug
472-57	1 hour CE Energy Saving Battery Charger, 220V/50Hz, 19.2V, AU Plug
472-54	Carrying / Shoulder Strap
472-55	Carrying Case / Blow Moulded Case
472-56	30" (760 mm) Replacement Hose

DELIVERS

Upto 85 gms / minute in free flow
Upto 3 oz. / minute in free flow



1.5Ah Ni-Cd
BATTERY PACKS

HYDRAULIC COUPLERS & SETS

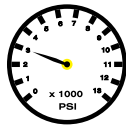

3,000 PSI
(207 BAR)

0.59"
(15 mm)



3,000 PSI
(207 BAR)

0.59"
(15 mm)



6,000 PSI
(413 BAR)

0.59"
(15 mm)

435-16

STANDARD

Ideal for use with grease guns for general maintenance

Narrow coupler design for use on fittings with limited access

Milled slot for easy tightening

Fully hardened spring steel jaws



4 JAW CONSTRUCTION



WITHOUT BALL CHECK



FOR HAND OPERATED
GREASE GUNS

PART NR.	THREADS
435-16	1/8" BSPT
435-17	M10 x 1
435-18	1/8" NPT

435-10

STANDARD

Most popular for use with grease guns for general maintenance

Narrow coupler design for use on fittings with limited access

Milled slot for easy tightening

Fully hardened spring steel jaws



4 JAW CONSTRUCTION



WITH BALL CHECK



FOR HAND OPERATED
GREASE GUNS

PART NR.	THREADS
435-10	1/8" BSPT
435-11	M10 x 1
* 435-12	1/8" NPT

Key * Best Seller

435-00

PROFESSIONAL

Best selling coupler for professional use

Hardened coupler body withstands high pressure without deformation

Fully hardened spring steel jaws

Hexagonal nut for easy tightening



4 JAW CONSTRUCTION



3 JAW CONSTRUCTION



WITH BALL CHECK

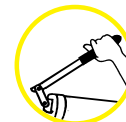

FOR HAND OPERATED
GREASE GUNS

PART NR.	THREADS
4 JAW COUPLERS	
* 435-00	1/8" BSPT
* 435-01	M10 x 1
* 435-02	1/8" NPT
3 JAW COUPLERS	
435-03	1/8" BSPT
435-04	M10 x 1
* 435-05	1/8" NPT

Key * Best Seller

**435-35****PROFESSIONAL**

For professional use

Hardened coupler body withstands high pressure without deformation

Fully hardened spring steel jaws

Hexagonal nut for easy tightening

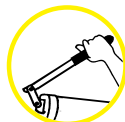
**4 JAW CONSTRUCTION****3 JAW CONSTRUCTION****WITHOUT BALL CHECK****FOR HAND OPERATED GREASE GUNS****435-90****PROFESSIONAL - SLIM**

For professional use

Amongst the Slimmest Jaw type Grease Coupler in the world! Ideal for use in confined spaces & fittings with narrow access

Hardened Coupler Body withstands high pressure without deformation

Fully hardened spring steel jaws

Coupler Nut & Body can be hand tightened for adjusting to variation in grease nipple sizes

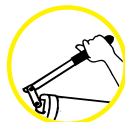
**3 JAW CONSTRUCTION****WITHOUT BALL CHECK****FOR HAND OPERATED GREASE GUNS**

PART NR.	THREADS
4 JAW COUPLERS	
435-35	1/8" BSPT
435-36	M10 x 1
435-37	1/8" NPT
3 JAW COUPLERS	
435-07	1/8" BSPT
435-08	M10 x 1
435-09	1/8" NPT

PART NR.	THREADS
435-90	1/8" BSPT
435-91	M10 X 1
435-92	1/8" NPT

26

HYDRAULIC COUPLERS - HEAVY DUTY

Recommended for use with air operated grease guns

Hardened coupler body with double wall thickness withstands high pressure without deformation

Fully hardened spring steel jaws

Hexagonal nut for easy tightening

PART NR.	THREADS
4 JAW COUPLERS	
435-20	1/8" BSPT
435-21	M10 x 1
* 435-22	1/8" NPT
3 JAW COUPLERS	
435-23	1/8" BSPT
435-24	M10 x 1
435-25	1/8" NPT

Key * Best Seller



**10,000 PSI
(690 BAR)**

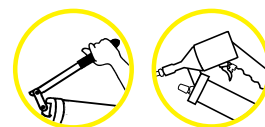

**FOR HAND AND AIR OPERATED
GREASE GUNS**



**3 JAW
CONSTRUCTION**



**4 JAW
CONSTRUCTION**



**WITH
BALL CHECK**

27

HYDRAULIC COUPLER - AIR-O

Recommended for use with grease control valves

Hardened coupler body & all internal parts withstand high dynamic pressures without deformation

Fully hardened reversible spring steel jaws for extended service life

Hexagonal nut for easy tightening

100% pressure tested

PART NR.	THREADS
3 JAW COUPLERS	
435-40	1/8" BSPT
435-41	M10 x 1
* 435-42	1/8" NPT

Key * Best Seller



**7,500 PSI
(517 BAR)**

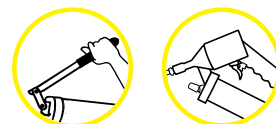

**FOR HAND AND AIR OPERATED
GREASE GUNS**



**3 JAW
CONSTRUCTION**



**WITH BALL
CHECK**

28

HYDRAULIC COUPLER - 90°

Designed for right angled discharge of grease.

Very useful for greasing fittings with limited access or in low heights where a grease gun with regular coupler is difficult to use, such as on Chrysler models

Fits all standard grease guns

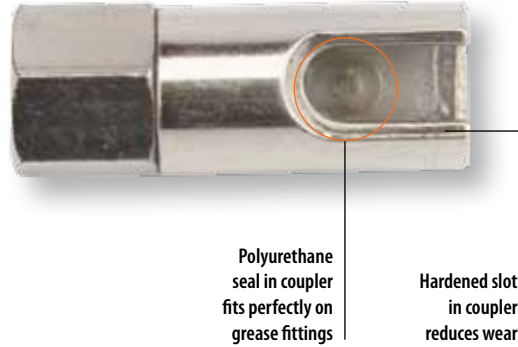

PART NR.	THREADS
435-50	1/8" BSPT
435-51	M10 x 1
* 435-52	1/8" NPT

Key * Best Seller



Right angled coupler used for greasing the axle of a low height truck where access to the grease fittings is only through a side



29

HYDRAULIC COUPLER - 360°

An excellent coupler for effective lubrication of difficult & hard to reach grease fittings

Jaws are fully hardened for extended service life

Hardened coupler body & swivel joints withstand high-pressure applications without deformation

Zinc plated finish

Spring loaded ball check valve helps retain pressure

Swivels in full 360° circle & locks conveniently at any 45° position. 45° angle gives easy access to most grease fittings

Hexagonal nut allows easy tightening



PART NR.	THREADS
435-60	1/8" BSPT
435-61	M10 x 1
* 435-62	1/8" NPT

Key * Best Seller

30

BUTTON HEAD COUPLERS

A range of couplers for use with button head grease fittings, found mostly on heavy machinery, agricultural or contractor's equipment

Zinc die cast construction

Couplers conveniently slide over the face of the button head fitting

All couplers have a metal seal that imparts increased resistance to wear

NOTE

Prolube also manufactures a range of Button Head Grease Fittings. Refer to page 51 for details

435-70

Swivelling
for 5/8" (16 mm)
Button Head Fittings



**3,000 PSI
(207 BAR)**



435-74

Fixed Hook-On
for 5/8" (16 mm)
Button Head Fitting



**3,000 PSI
(207 BAR)**



435-77

Fixed Push-On
for 5/8" (16 mm)
Button Head Fittings



**3,000 PSI
(207 BAR)**



435-79

Medium Duty
for 5/8" (16 mm)
Button Head Fittings



**6,000 PSI
(413 BAR)**



435-78

Heavy Duty
for 7/8" (22 mm)
Giant Button Head
Fittings



**7,500 PSI
(517 BAR)**



PART NR.	FOR BUTTON HEAD FITTING SIZE	THREADS
* 435-70	5/8" (16 mm)	1/8" BSPT
435-72	5/8" (16 mm)	1/8" NPT
* 435-74	5/8" (16 mm)	1/8" BSPT
435-75	5/8" (16 mm)	M10 x 1
435-69	5/8" (16 mm)	1/8" NPT
435-77	5/8" (16 mm)	1/8" BSPT
435-63	5/8" (16 mm)	M10 x 1
435-64	5/8" (16 mm)	1/8" NPT
435-79	5/8" (16 mm)	1/8" BSPT
435-65	5/8" (16 mm)	M10 x 1
435-76	5/8" (16 mm)	1/8" NPT
435-78	7/8" (22 mm)	1/8" BSPT
435-66	7/8" (22 mm)	M10 x 1
435-67	7/8" (22 mm)	1/8" NPT

Key * Best Seller

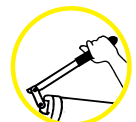

**FOR HAND OPERATED
GREASE GUNS**

31

HYDRAULIC COUPLER -
PIN TYPE

Provides quick, positive and leakproof connection with pin type fittings

Hexagonal nut allows easy tightening

NOTE

PROLUBE also manufactures a range of Pin Type Grease Fittings. Refer to page 51 for details

PART NR.	THREADS
* 435-30	1/8" BSPT
435-32	M10 X 1
435-31	1/8" NPT

Key * Best Seller



3,000 PSI
(207 BAR)



WITHOUT BALL
CHECK



FOR HAND OPERATED
GREASE GUNS

32

NEEDLE NOSE
DISPENSERS

Used for dispensing a fine line of grease

Needle design allows operator to contact flush on hard to reach hydraulic type fittings in inaccessible areas

Can be attached directly to steel extensions or flexible hoses

Special model available with shroud



448-50



448-53



448-51



448-52



Needle Nose Dispenser
used to Grease a fitting
with limited access

PART NR.	PART NR.	NEEDLE LENGTH		NEEDLE DIAMETER		TIP DIAMETER	
1/8" BSPT	1/8" NPT	inch	mm	inch	mm	inch	mm
NEEDLE NOSE DISPENSERS							
448-50	448-60	* 19/32"	15	0.187"	4.76	0.046"	1.17
448-53	-	19/32"	15	0.187"	4.76	0.046"	1.17
448-54	Replacement shroud only						
NARROW NEEDLE NOSE DISPENSERS							
448-51	448-61	* 1.1/2"	38	0.156"	3.96	0.059	1.17
448-52	448-62	6"	150	0.156"	3.96	0.059	1.17

Key * Best Seller



6,000 PSI
(413 BAR)

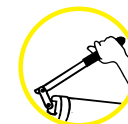

FOR HAND OPERATED
GREASE GUN

33

GREASE INJECTOR NEEDLES

Lubricates in very tight spaces such as universal joints and sealed bearings

Equipped with grease fitting for quick connect operation

Complete with protective plastic holder

Available in standard or safety version with Aluminum Holder for safe & easy handling

448-80

Stainless Steel
1.1/2" (38 mm)
long needle



448-82

Aluminum Holder
with Stainless Steel
36mm long needle



PART NR.	TYPE	NEEDLE LENGTH	NEEDLE THICKNESS (GAUGE)
448-79	Standard	1-1/2" (38 mm)	16
* 448-80	Standard	1-1/2" (38 mm)	18
448-81	Standard	1-1/2" (38 mm)	21
448-82	Safety	36 mm	18

Key * Best Seller



1,000 PSI
(69 BAR)



FOR HAND OPERATED
GREASE GUNS

34

SEAL OFF DISPENSER

Used for lubricating cars with grease plugs

Oil & grease resistant rubber tip

Used with grease gun extension or hose

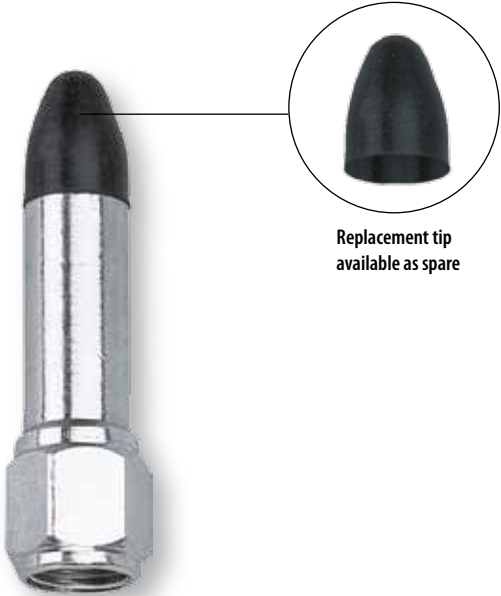

Replacement tip
available as spare

PART NR.	THREADS
448-70	1/8" BSPT
448-71	1/8" NPT
448-72	(Replacement Tip Only)



FOR HAND OPERATED
GREASE GUNS

35

GREASE GUN HOLDERS

Simple snap action clamps for safe storage of grease guns and suction guns

Mount on almost any surface

Manufactured from heavy gauge steel sheet with zinc plated finish

448-40

448-41

PART NR.	SUITABLE FOR BARREL DIAMETER
* 448-40	2.1/4" (57.15 mm) on guns suitable for 14 oz. (400 gm) cartridge
448-41	63.5 mm on guns suitable for 450 gms cartridge popular in Australia & New Zealand

Key * Best Seller

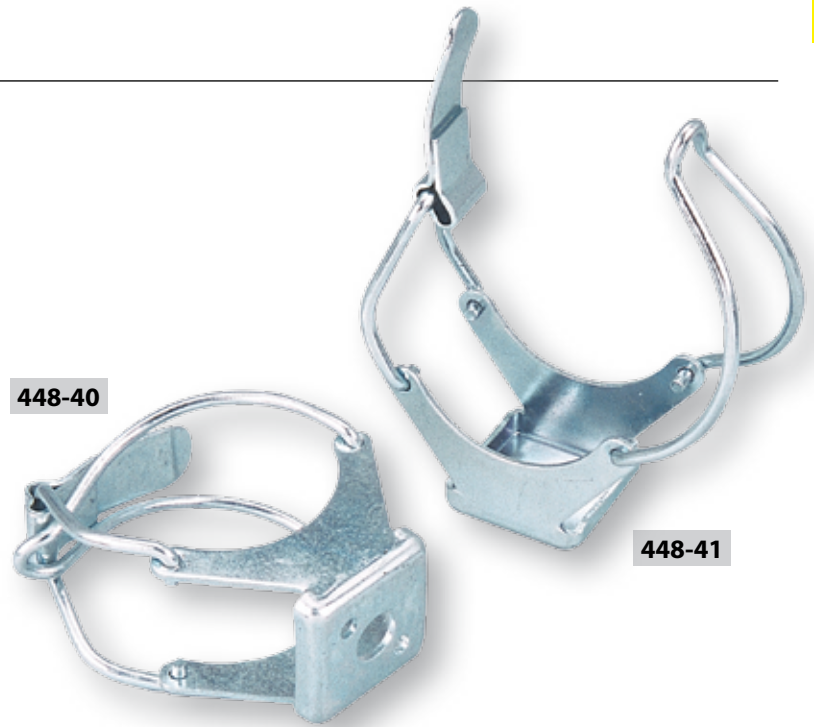

36

HEAVY DUTY GREASE GUN HOLDER

Heavy Duty Grease Gun holder, designed especially for use on farm & construction equipment, trailers, tractors & other automobiles in high vibration environment

Sturdy all steel construction with a 4 bolt design for convenient & secure mounting

Heavy Duty Spring

Works with both 14 oz. (400 gm) capacity Grease Guns with a 2-1/4" (57 mm) dia. and 450 gm capacity Grease Guns with 63.5 mm dia. popular in Australia & New Zealand

4 Bolt Design

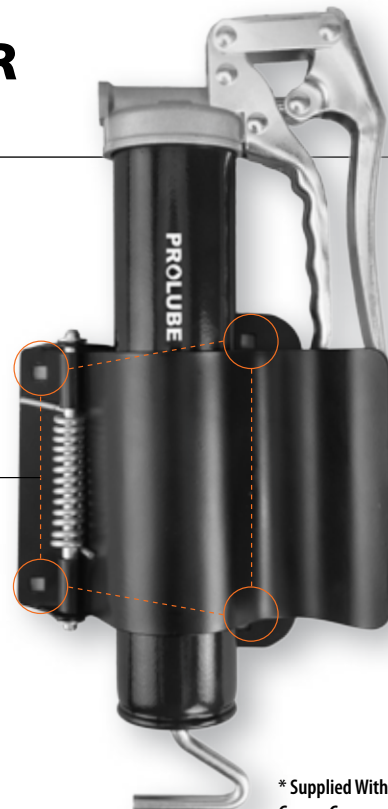

* Supplied Without Grease Gun

PART NR.	SUITABLE FOR BARREL DIAMETER
448-42	2.1/4" (57.15 mm) & 63.5 mm barrels popular in Australia & New Zealand

37

GREASE GUN HOSES

Grease hoses allow greasing access to nipples with limited reach. Due to their flexible construction, these are used for greasing hard to reach grease fittings

Thermoplastic construction with 0.14" (3.6 mm) inner diameter & 0.33" (8.5 mm) outer diameter

Highly flexible with minimum bending radius of 1.57" (40 mm)

Zinc plated steel end connections with hydraulic crimping

Select lengths available in the following variations:

- a. Hose fitted with spring guard
- b. Hose fitted with professional 4 jaw coupler with ball check
- c. Hose fitted with Swivel

WARNING

Never use beyond recommended working pressure

USEFUL TIPS!

Always buy a good quality hose. Accidents caused by poor quality hose can cause fatal injury

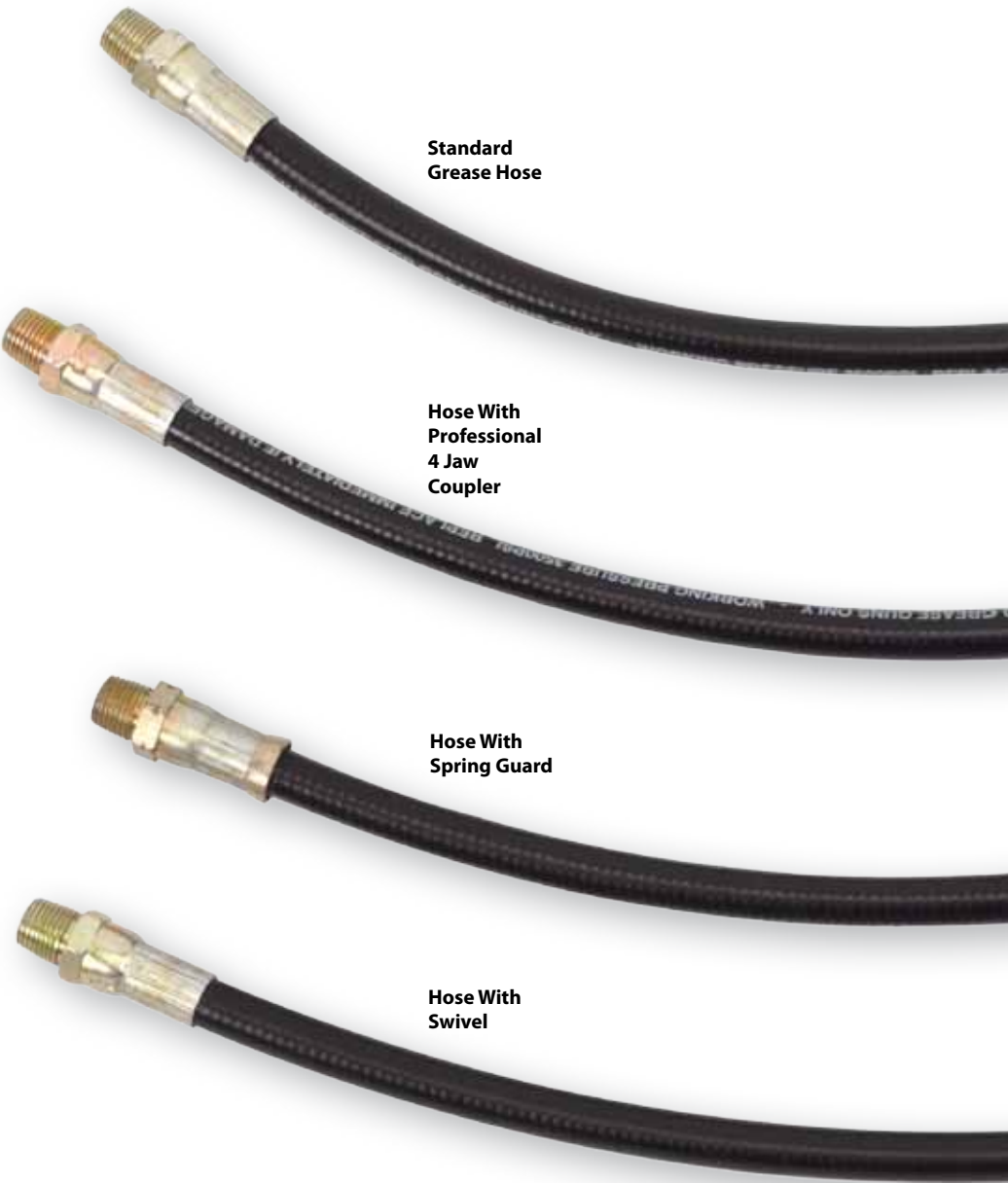

Standard Grease Hose

PART NR.	PART NR.	PART NR.	LENGTH (END TO END)
1/8" BSPT	M10 X 1	1/8" NPT	
436-00	436-10	436-20	6" (150 mm)
436-01	436-11	436-21	8" (200 mm)
436-02	436-12	436-22	9" (225 mm)
436-03	436-13	436-23	10" (250 mm)
* 436-04	* 436-14	* 436-24	12" (300 mm)
* 436-05	* 436-15	* 436-25	18" (450 mm)
436-06	* 436-16	436-26	20" (500 mm)

Key * Best Seller

Hose With Professional 4 Jaw Coupler

PART NR.	LENGTH (END TO END)	THREADS
* 436-30	12" (300mm)	1/8" BSPT
436-31	18" (450 mm)	1/8" BSPT
* 436-40	12" (300mm)	M10 x 1
436-41	18" (450 mm)	M10 x 1
* 436-50	12" (300mm)	1/8" NPT
* 436-51	18" (450 mm)	1/8" NPT

Other lengths can be custom manufactured



WORKING PRESSURE
3,500 PSI (240 BAR)

BURST PRESSURE
11,600 PSI (800 BAR)



**FOR HAND OPERATED
GREASE GUNS**

Hose fitted with
Professional
4 Jaw Coupler
with Ball Check

Hose fitted with heavy duty
spring guard that imparts
rigidity to the coupling end
of the hose, allowing added
safety & convenience in
fitment

Hose fitted
with swivel

Hose With Spring Guard

PART NR.	LENGTH (END TO END)	THREADS
436-60	12" (300mm)	1/8" BSPT
436-61	18" (450 mm)	1/8" BSPT
436-70	12" (300mm)	M10 x 1
436-71	18" (450 mm)	M10 x 1
* 436-80	12" (300mm)	1/8" NPT
* 436-81	18" (450 mm)	1/8" NPT

Hose With Swivel

PART NR.	LENGTH (END TO END)	THREADS
436-85	12" (300mm)	1/8" BSPT
436-88	18" (450 mm)	1/8" BSPT
436-86	12" (300mm)	M10 x 1
436-89	18" (450 mm)	M10 x 1
436-87	12" (300mm)	1/8" NPT
436-90	18" (450 mm)	1/8" NPT



38

GREASE GUN HOSES -
HEAVY DUTY

Superior Construction – Inner tubing is polyamide with polyurethane sheathing, reinforced diagonally in highly tear resistant polyester

Hose has an inner diameter of 0.16" (4.1 mm) & an outer diameter of 0.425" (10.8 mm). **Large inner diameter makes them ideal for use in cold weather**

Heavy duty zinc plated end connections hydraulically crimped to the hose

Rolled threads for extra strength

Select lengths also available in the following variations

- a. Hose fitted with heavy-duty spring guard. Used primarily with Grease Control Valves
- b. Hose fitted with professional 4 jaw coupler with ball check

Other lengths can be custom manufactured

!

WARNING

Never use beyond recommended working pressure

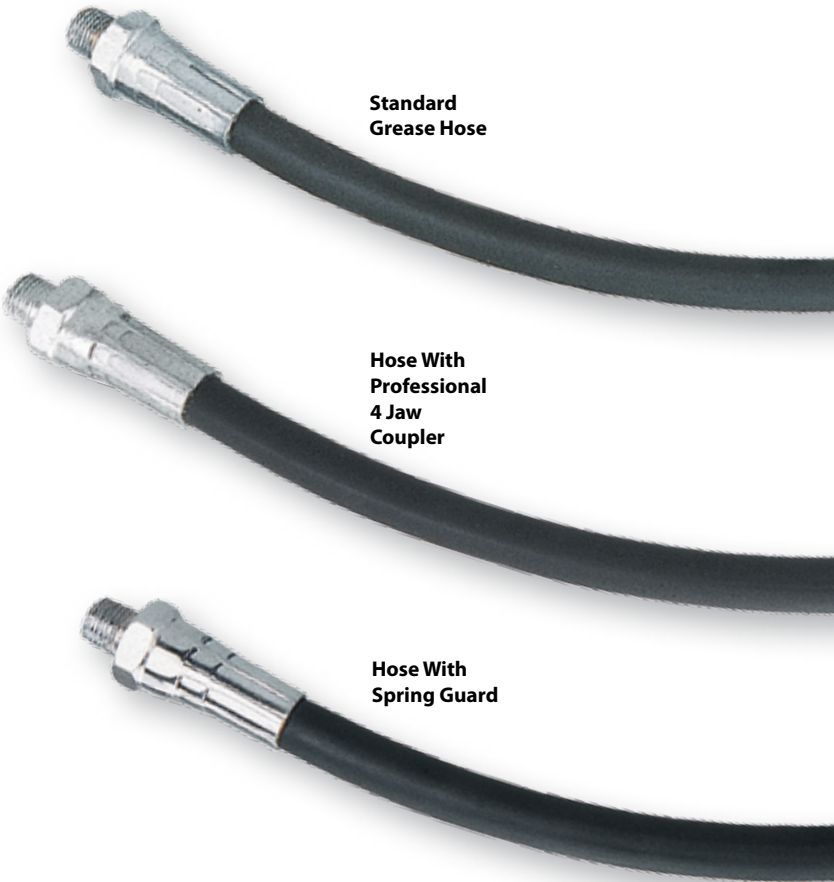

Standard Grease Hose

PART NR.	LENGTH (END TO END)	THREADS
* 437-00	12" (300 mm)	1/8" BSPT
* 437-01	18" (450 mm)	1/8" BSPT
437-02	20" (500 mm)	1/8" BSPT
* 437-10	12" (300 mm)	M10 x 1
* 437-11	18" (450 mm)	M10 x 1
* 437-12	20" (500 mm)	M10 x 1
437-20	12" (300 mm)	1/8" NPT
* 437-21	18" (450 mm)	1/8" NPT
* 437-22	20" (500 mm)	1/8" NPT

Key Best Seller



WORKING PRESSURE
5,800 PSI (400 BAR)

BURST PRESSURE
13,775PSI (950 BAR)

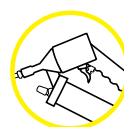

**FOR HAND AND AIR OPERATED
GREASE GUNS**

Hose fitted with
Professional
4 Jaw Coupler
with Ball Check

Hose fitted with
heavy-duty spring guard.
Used primarily with grease
control valves



USEFUL TIPS!

**Always buy a good quality hose.
Accidents caused by poor quality
hose can cause fatal injury**

Hose with Professional 4 Jaw Coupler

PART NR.	LENGTH (END TO END)	THREADS
* 437-30	12" (300 mm)	1/8" BSPT
* 437-31	18" (450 mm)	1/8" BSPT
* 437-40	12" (300 mm)	M10 x 1
* 437-41	18" (450 mm)	M10 x 1
* 437-50	12" (300 mm)	1/8" NPT
* 437-51	18" (450 mm)	1/8" NPT

Hose with Spring Guard

PART NR.	LENGTH (END TO END)	THREADS
437-60	12" (300 mm)	1/8" BSPT
437-61	18" (450 mm)	1/8" BSPT
437-70	12" (300 mm)	M10 x 1
437-71	18" (450 mm)	M10 x 1
* 437-80	12" (300 mm)	1/8" NPT
* 437-81	18" (450 mm)	1/8" NPT

39

FLEXIBLE / RIGID GREASE GUN EXTENSION

Grease Gun Extension that works as a firm & rigid 13" (330 mm) long steel extension or converts into a flexible hose extension for greasing hard to reach fittings

Switches with one hand by a simple slide of the steel tube

Supplied complete with Grease Gun Coupler

Ideal for use with Grease Control valves

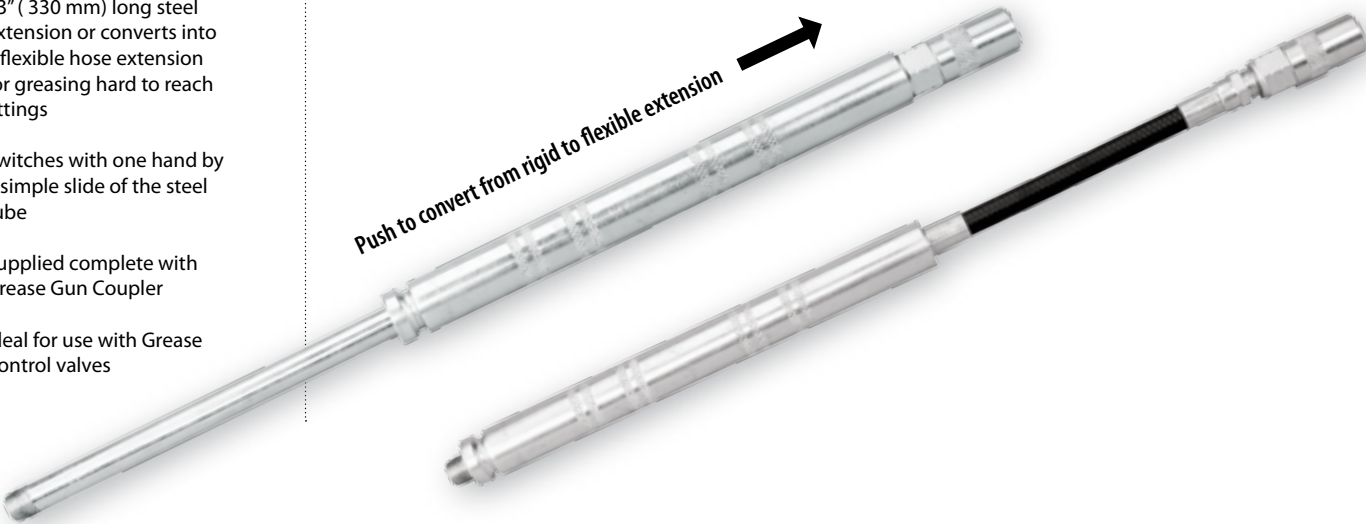

PART NR.	THREADS
448-10	1/8" BSPT
448-11	M10 x 1
* 448-12	1/8" NPT

Key * Best Seller

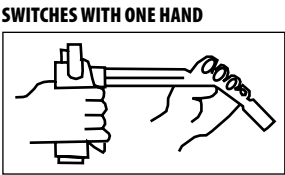

40

GREASE GUN EXTENSION SWIVEL

Grease Gun extension swivel threaded 1/8" Male x 1/8" Female

Female end of the swivel fits onto the Grease Gun extension & male end onto the Grease Gun outlet, enabling unrestricted movement without any bending, twisting or kink

All steel construction in plated finish

PART NR.	THREADS
448-85	1/8" BSPT
448-86	M10 x 1
448-87	1/8" NPT



41

GREASE GUN STEEL
EXTENSIONS

Steel construction with bright zinc plated finish

High strength rolled threads on both ends

Available in straight & bent construction

PART NR.	LENGTH (END TO END)	THREADS
BENT		
448-00	6" (150 mm)	1/8" BSPT
448-01	6" (150 mm)	M10 X 1
448-02	6" (150 mm)	1/8" NPT
448-04	8" (200 mm)	M10 X 1
448-09	18" (450 mm)	1/8" NPT
STRAIGHT		
448-20	4" (100 mm)	1/8" BSPT
448-21	4" (100 mm)	M10 X 1
448-22	4" (100 mm)	1/8" NPT
448-23	5" (125 mm)	1/8" NPT
448-27	6" (150 mm)	1/8" BSPT
448-29	6" (150 mm)	1/8" NPT
448-17	8" (200 mm)	M10 X 1



42

GREASE GUN LIGHT

Extremely useful accessory for grease guns

Makes it easy to locate grease fittings in dark areas, shoulders & other difficult to locate points

Slim construction with a powerful LED

Fits both on grease gun steel extensions & flexible hoses with ease

Includes 3 LR 41 button cells



PART NR.

550-15

43

BULK LOADERS /
FILLER NIPPLES

Spare loader valves for bulk loading grease guns using Filler pump

Built in Ball Check

Zinc plated finish



PART NR.	PART NR.	PART NR.	TYPE
1/8" BSPT	M10 X 1	1/8" NPT	
● 448-30	● 448-33	● 448-35	Straight
448-31		448-34	Tapered
		448-36	Tapered

● Used on PROLUBE Grease Guns as standard

44

AIR RELEASE VALVES

Spare bleeder fitting for grease guns

Available in Manual & Automatic versions

Vents air pockets in grease guns efficiently

Zinc plated finish

PART NR.	THREADS
MANUAL	
448-39	1/8" BSPT
4483-7	M10 x 1
448-38	1/8" NPT
AUTOMATIC	
448-97	1/8" BSPT
448-98	M10 x 1
448-99	1/8" NPT



Press down to release trapped air in grease

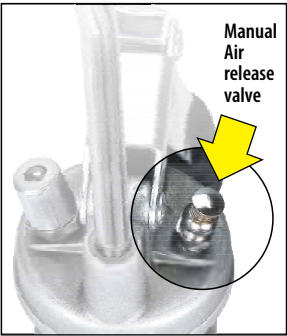

45

DELUXE STEEL BEARING PACKERS

Useful for greasing bearings in cars, boats, tractors, RV's etc

Rugged steel construction



USEFUL TIPS!

Always use recommended grade of grease. Some grades of grease cannot handle temperatures of wheel bearing applications

Do not use compressed air for cleaning the bearing prior to use with the bearing packer. This is unsafe and could damage the race



448-47

Rapid action Bench Type Bearing Packer for use with Grease Guns. Non threaded top cone for fast placement of bearings. The design incorporates grease nipple on the outer shaft, which easily adapts to the grease gun coupler. Suited for bearings with a min. inner diameter of 1/2" (12 mm), to a max. outer diameter of 6" (150 mm) and height from 3/8" (10 mm) to 2" (50 mm)



448-45

Bearing Packer with threaded center post for use with Grease Guns. The design incorporates grease nipple at one end, which easily adapts to the grease gun coupler. Suited for bearings with a min. inner diameter of 1/2" (12 mm), to a max. outer diameter of 5" (125 mm) and height from 1/4" (6 mm) to 2" (50 mm)



448-48

Rapid action Bearing Packer for use with Grease Gun Filler Pump. Non threaded top cone for fast placement of bearings. Outer shaft is threaded 1/4" NPT (F) & fits onto the Outlet Discharge Tube of the Grease Filler Pump. Suited for bearings with a min. inner diameter of 1/2" (12 mm), to a max. outer diameter of 6" (150 mm) and height from 3/8" (10 mm) to 2" (50 mm)

PART NR.	DESCRIPTION
448-45	For use with Grease Guns
448-47	For use with Grease Guns
448-48	For use with Filler Pump

46

GREASE FEEDERS

Grease Feeders are used to provide single point controlled lubrication for all types of bearing housings thereby eliminating difficulties arising due to over or under greasing

Working on a spring compression mechanism, the design regulates grease discharge in proportion to changing spring pressure, thus maintaining constant discharge pressure of 1- 2 PSI

Assembled with medium duty spring, the light & heavy duty springs come as spares in the pack and can be easily interchanged depending upon application

Can be mounted in any position for easy visual inspection of grease levels

Reusable: Can be refilled easily with immediate activation.

1/8" (M) steel adaptor at the tail end fits directly onto bearing housings Thread converters & angle adaptors available as spares

Remote Refill kit also available that permits remote filling of grease from distances up to 3 meters (10')

RECOMMENDED USE

For use with NLGI 0 to 4 non separating grease on any equipment that

- has anti friction, oscillating or roller bearings
- has shielded bearings with seals
- has bronze, olite or open bearings
- requires bearing flushing action



477-01

! WARNING

Do not use with ESTER based greases, synthetic greases such as Aeroshell 33 Grease, Aeroshell 7 Grease, Skydrol Products etc. These have an adverse effect on polycarbonate & can cause fogging , cracking & fracturing

Dome	Polycarbonate
Base	Polycarbonate
Temperature	-23°C to 121°C (-10°F to 250°F)
Application	Static Non Vibratory Conditions

PART NR.	PART NR.	BOWL CAPACITY	OPERATING CONDITION	OVERALL DIA.	OVERALL HEIGHT
1/8" BSPT THREADS	1/8" NPT THREADS				
POLYCARBONATE BOWL & BASE					
477-00	477-20	1 oz. (28 gms)	Static	1-3/4" (45 mm)	3-5/8" (92 mm)
477-01	477-21	2 oz. (56 gms)	Static	2-3/8" (60 mm)	4-5/8" (117 mm)
477-02	477-22	6 oz. (170 gms)	Static	3" (75 mm)	6" (150 mm)
POLYCARBONATE BOWL & ALUMINIUM BASE					
477-03	477-23	1 oz. (28 gms)	Dynamic	1-3/4" (45 mm)	3-5/8" (92 mm)
477-04	477-24	2 oz. (56 gms)	Dynamic	2-3/8" (60 mm)	4-5/8" (117 mm)
477-05	477-25	6 oz. (170 gms)	Dynamic	3" (75 mm)	6" (150 mm)
POLYCARBONATE BOWL & NICKEL PLATED ALUMINIUM BASE					
477-06	477-26	1 oz. (28 gms)	Corrosive	1-3/4" (45 mm)	3-5/8" (92 mm)
477-07	477-27	2 oz. (56 gms)	Corrosive	2-3/8" (60 mm)	4-5/8" (117 mm)
477-08	477-28	6 oz. (170 gms)	Corrosive	3" (75 mm)	6" (150 mm)
BOROSILICATE BOWL & ALUMINIUM BASE					
477-09	477-29	4 oz. (113 gms)	High Temperature / Nuclear Environments	3-1/4" (82 mm)	7-1/8" (181 mm)
477-90	3 m (10') Grease Hose with all fittings				

**477-04**

Dome	Polycarbonate
Base	Die Cast Aluminium
Temperature	-23°C to 121°C (-10°F to 250°F)
Application	Dynamic applications involving vibration & shocks

**477-07**

Dome	Polycarbonate
Base	Die Cast Aluminium with Nickel Plating
Temperature	-23°C to 121°C (-10°F to 250°F)
Application	Corrosive environments for dynamic applications involving vibrations & shocks: chemical plants, food industry etc.

**477-09**

Dome	Tempered borosilicate with stainless steel cap
Base	Aluminium
Temperature	-23°C to 232°C (-10°F to 450°F)
Application	Very high temperature applications: nuclear plants, steel mills, lumber drying kilns etc.

**BLUE:**
Light Spring**SILVER:**
Medium Spring**RED:**
Heavy Spring**SPRING SELECTION GUIDE**

Operating Temperature		NLGI Grease Type				
From	To	No. 0	No. 1	No. 2	No. 3	No. 4
-23°C (-10°F)	4°C (40°F)	Blue	Silver	Red		
4°C (40°F)	43°C (110°F)	Blue	Silver	Silver	Red	
43°C (110°F)	93°C (200°F)		Blue	Silver	Silver	Red
93°C (200°F)	121°C (250°F)			Blue	Silver	Red

Remote
Grease
Refill Kit**SIZE SELECTION GUIDE**

Bearing Shaft Dia.	Upto 1-1/2" (38 mm)				1-1/2" (38 mm) & over			
Operating Condition	Intermittent		Continuous		Intermittent		Continuous	
Class of Bearing	Open	Sealed	Open	Sealed	Open	Sealed	Open	Sealed
Under 1000 RPM	1 oz.	1 oz.	1 oz.	1 oz.	2 oz.	2 oz.	2 oz.	2 oz.
1000 to 2500 RPM	1 oz.	1 oz.	1 oz.	1 oz.	2 oz.	2 oz.	6 oz.	6 oz.
Over 2500 RPM	2 oz.	1 oz.	2 oz.	2 oz.	6 oz.	6 oz.	6 oz.	6 oz.



**6,000 PSI
(413 BAR)**

Manufactured to the most stringent quality standards – TS16949 approved manufacturing

Available in a range of materials: EN-1A steel, 303 Stainless Steel, Brass etc.

Fitting profile & dimensions are accurately controlled & conform to SAE, DIN, BS, JIS & IS standards

Grease fittings are heat treated to SAE J534 specification with hardness on greasing end to a minimum of 83 on Rockwell 15N scale with a case depth of 0.005" (0.13 mm) to 0.009" (0.23 mm)

Fittings with ball check use heat treated springs for increased life

Steel fittings are plated in yellow zinc with a plating thickness of 0.0002" (5 microns) conforming to ASTM B117 specification & have a guaranteed salt spray life of over 75 hours to red rust. Fittings can be custom manufactured in white zinc & also be made with trivalent passivation

Also available 303 stainless steel fittings for marine applications

Available ready from stock in a large selection of popular types & sizes, with many more variations custom manufactured



PART NR.		DESCRIPTION	DIMENSIONS (FOR GUIDANCE ONLY)			
			EFFECTIVE THREAD LENGTH	SHANK LENGTH	OVERALL LENGTH	HEX SIZE
1/4" -28 SAE-LT - TAPER THREAD						
*	460-00	Straight	2.5 mm min.	4.6 mm	13.7 mm	5/16"
	460-02	Straight	5.1 mm min.	8.6 mm	17.3 mm	5/16"
*	460-03	45°	2.5 mm min.	5.1 mm	20.8 mm	3/8"
	460-05	65°	2.5 mm min.	5.1 mm	18.5 mm	3/8"
*	460-06	90°	2.5 mm min.	5.1 mm	19.3 mm	3/8"
1/4" - 28 SPL. SELF FORMING THREADS						
	460-30	Straight	2.5 mm min.	5.1 mm	14.0 mm	5/16"
	460-31	45°	2.5 mm min.	4.8 mm	20.3 mm	3/8"
	460-32	90°	2.5 mm min.	4.8 mm	19.3 mm	3/8"
1/8" X 28 BSPT - TAPER THREADS						
*	461-13	Straight	3.75 mm	5.5 mm	16.0 mm max.	11.0 mm
	461-16	Straight	6.5 mm	8.0 mm	20.0 mm max.	11.0 mm
*	461-14	45°	3.75 mm	5.5 mm	21.0 mm max.	11.0 mm
	461-17	45°	6.5 mm	8.0 mm	26.3 mm	11.0 mm
*	461-15	90°	3.75 mm	5.5 mm	18.0 mm	11.0 mm
	461-18	90°	6.5 mm	8.0 mm	21.4 mm	11.0 mm
1/4" X 19 BSPT - TAPER THREADS						
	461-03	Straight	4.2 mm	6.5 mm	17.5 mm	9/16"
	461-06	Straight	9.2 mm	10.7 mm	23.5 mm	0.60"
	461-04	45°	4.2 mm	6.5 mm	22.5 mm	9/16" or 14 mm
	461-05	90°	4.2 mm	6.5 mm	22.0 mm	9/16" or 14 mm
UNF - PARALLEL THREADS						
	465-00	Straight 1/4"-28	2.5 mm min.	4.6 mm	15.0 mm	8.0 mm
	465-01	Straight 5/16"-24	4.0 mm min.	6.35 mm	16.7 mm	7/16"
	465-03	Straight 3/8"-24	4.4 mm min.	6.8 mm	16.7 mm	7/16"
BSF - PARALLEL THREADS						
	465-20	Straight 1/4"-26	2.0 mm min.	4.6 mm	13.9 mm	7.0 mm
	465-21	Straight 5/16"-22	2.5 mm min.	5.5 mm	15.0 mm	9.0 mm
	465-22	Straight 3/8"-20	3.7 mm min.	5.5 mm	18.0 mm max.	11.0 mm
1/8" - 27 PIPE THREADS PTF - SPECIAL SHORT						
	460-46	Straight	4.0 mm min.	5.95 mm	14.3 mm	7/16"
*	460-35	Straight	4.6 mm min.	7.1 mm	16.8 mm	7/16"
	460-37	Straight	5.6 mm min.	19.3 mm	32.0 mm	7/16"
	460-40	30°	5.6 mm min.	7.6 mm	22.9 mm	7/16"
*	460-41	45°	5.6 mm min.	7.6 mm	21.8 mm	7/16"
*	460-42	65°	5.6 mm min.	7.6 mm	21.8 mm	7/16"
*	460-44	90°	5.6 mm min.	7.6 mm	21.3 mm	7/16"
1/8" - 27 SPL. SELF FORMING THREADS						
	460-70	Straight	3.6 mm min.	6.1 mm	15.7 mm	7/16"
	460-71	45°	2.8 mm min.	5.1 mm	19.8 mm	7/16"
	460-72	90°	2.8 mm min.	5.1 mm	19.3 mm	7/16"

Key * Best Seller

Grease Fittings
StraightGrease Fitting
Angled -45°Grease Fitting
Angled -90°Grease Fitting
Pin TypeButton Head
Grease Fitting

PART NR.	DESCRIPTION	DIMENSIONS (FOR GUIDANCE ONLY)				
		EFFECTIVE THREAD LENGTH	SHANK LENGTH	OVERALL LENGTH	HEX SIZE	
1/4" - 18 PIPE THREADS - SPECIAL EXTRA SHORT						
*	460-20	Straight	6.0 mm min.	10.7 mm	22.0 mm	9/16"
	460-22	45°	5.75 mm min.	9.27 mm	29.74 mm	9/16"
*	460-21	65°	5.6 mm min.	8.7 mm	24.6 mm	9/16"
	460-23	90°	5.75 mm min.	9.27 mm	24.0 mm	9/16"
6.0 MM X 1.0 MM TAPER THREADS						
*	462-00	Straight	3.75 mm min.	5.5 mm max.	16.0 mm max.	7.0 mm
*	462-01	45°	4.5 mm min.	5.5 mm max.	21.0 mm max.	9.0 mm
*	462-02	90°	4.5 mm min.	5.5 mm max.	18.0 mm max.	9.0 mm
8.0 MM X 1.0 MM TAPER THREADS						
*	462-20	Straight	5.5 mm min.	6.5 mm max.	16.0 mm max.	9.0 mm
*	462-22	45°	3.75 mm min.	5.5 mm max.	21.0 mm max.	9.0 mm
*	462-23	90°	3.75 mm min.	5.5 mm max.	18.0 mm max.	9.0 mm
8.0 MM X 1.25 MM TAPER THREADS						
	462-21	Straight	3.75 mm min.	5.5 mm max.	17.0 mm max.	9.0 mm
	462-24	45°	3.7 mm min.	5.5 mm max.	21.0 mm max.	9.0 mm
	462-25	90°	3.7 mm min.	5.5 mm max.	18.0 mm max.	9.0 mm
10.0 MM X 1 MM TAPER THREADS						
*	462-30	Straight	3.75 mm min.	5.5 mm max.	16.0 mm max.	11.0 mm
*	462-31	45°	3.75 mm min.	5.5 mm max.	21.0 mm max.	11.0 mm
*	462-32	90°	3.75 mm min.	5.5 mm max.	18.0 mm max.	11.0 mm
10.0 MM X 1.5 MM TAPER THREADS						
	462-40	Straight	3.75 mm min.	5.5 mm max.	18.0 mm max.	11.0 mm
	462-41	45°	3.75 mm min.	5.5 mm max.	21.0 mm max.	11.0 mm
	462-42	90°	3.75 mm min.	5.5 mm max.	18.0 mm max.	11.0 mm
DRIVE FITTINGS						
	463-00	For 3/16" Drill	N.A	6.35 mm	13.1 mm	Dia. 5/16" (7.94 mm)
*	463-04	For 1/4" Drill	N.A	6.35 mm	13.9 mm	Dia. 11/32" (8.73 mm)
	463-02	For 5/16" Drill	N.A	6.35 mm	13.9 mm	Dia. 3/8" (9.53 mm)
BUTTON HEAD GREASE FITTING - PARALLEL THREADS						
	464-00	1/4" x 19 BSPT	7.0 mm min	10.7 mm	21.0 mm	15.24 mm
	464-01	1/8" x 28 BSPT	4.0 mm min.	7.4 mm	15.3 mm	15.24 mm
BUTTON HEAD GREASE FITTING - TAPER THREADS						
	464-20	1/8" - 27 PTF SAE spl. Short	4.76 mm min.	8.7 mm	19.0 mm	5/8"
	464-21	3/8" - 18 NPTF	9.5 mm min.	12.3 mm	24.2 mm	3/4"
	464-22	1/4" - 18 NPTF	6.75 mm min.	10.7 mm	21.0 mm	5/8"
GREASE FITTINGS - PIN TYPE - BRASS CONSTRUCTION						
	439-01	1/8" BSPT	7.0 mm	8.0 mm	27.0 mm	10.0 mm
	439-00	1/4" BSPT	10.0 mm	11.0 mm	30.0 mm	14.0 mm
	439-03	1/8" NPT	7.0 mm	8.0 mm	27.0 mm	10.0 mm
	439-02	1/4" NPT	10.0 mm	11.0 mm	30.0 mm	14.0 mm
STAINLESS STEEL GREASE FITTINGS						
	466-00	Straight, 1/4" - 28 SAE LT	2.5 mm min.	4.6 mm	13.7 mm	5/16"
	466-01	45°, 1/4" - 28 SAE LT	2.5 mm min.	5.1 mm	20.8 mm	3/8"
	466-02	90°, 1/4" - 28 SAE LT	2.5 mm min.	5.1 mm	19.3 mm	3/8"
	466-10	Straight, 1/8" - 27 PTF	4.6 mm min.	7.1 mm	16.8 mm	7/16"
	466-11	45°, 1/8" - 27 PTF	5.6 mm min.	7.6 mm	21.8 mm	7/16"
	466-12	90°, 1/8" - 27 PTF	5.6 mm min.	7.6 mm	21.3 mm	7/16"
	466-20	Straight, 1/4" - 18 PTF	6.0 mm min.	10.7 mm	22.0 mm	9/16"
	466-30	Straight, M6 x 1	3.75 mm min.	5.5 mm max.	16.0 mm max.	7.0 mm
	466-40	Straight, 1/8" - 28 BSPT	3.75 mm min.	5.5 mm max.	16.0 mm max.	11.0 mm

48

GREASE FITTING SETS

439-76

50 pcs of BSPT Grease Fittings packed to a plastic box

THREAD SPEC.	STRAIGHT	45°	90°
1/8"-28 BSPT	20	5	5
1/4"-19 BSPT	10	5	5



439-81

44 pcs of Metric Grease Fittings packed to a plastic box

THREAD SPEC.	STRAIGHT	45°	90°
M6 x 1	10	6	6
M8 x 1	6		6
M10 x 1	10		



439-82

40 pcs of Stainless Steel SAE Grease Fittings packed to a plastic box

THREAD SPEC.	STRAIGHT	45°	90°
1/8"-27 PTF	10	5	5
1/4"-28 SAE-LT	10	5	5



439-70

110 pcs of SAE Grease Fittings packed to a plastic box

THREAD SPEC.	STRAIGHT	45°	90°
1/8"-27 PTF	30	15	15
1/4"-28 SAE-LT	20	15	15

439-71

110 pcs of Metric Grease Fittings packed to a plastic box

THREAD SPEC.	STRAIGHT	90°
M6 X 1	30	20
M8 X 1	20	10
M10 X 1	20	10



439-72

* 80 pcs of SAE Grease Fittings packed to a plastic box

THREAD SPEC.	STRAIGHT	45°	90°
1/8"-27 PTF	25	10	10
1/4"-28 SAE-LT	15	10	10

* Best Seller

439-73

* 80 pcs of Metric Grease Fittings packed to a plastic box

THREAD SPEC.	STRAIGHT	90°
M6 X 1	20	10
M8 X 1	15	10
M10 X 1	15	10



439-77

- * 101 pcs of SAE Grease Fittings & Grease Fitting Tools packed to a plastic box

THREAD SPEC.	STRAIGHT	30°	45°	65°	90°
1/8"-27 PTF	22	5	10	10	10
1/4"-28 SAE-LT	22		10		10
448-90 Easy Out Tool (Small)		1			
448-91 Easy Out Tool (Large)		1			

- * Best Seller

439-78

- * 101 pcs of Metric Grease Fittings & Grease Fitting Tools packed to a plastic box

THREAD SPEC.	STRAIGHT	45°	90°
M6 X 1	30	5	10
M8 X 1	14		5
M10 X 1	20	5	10
448-90 Easy Out Tool (Small)		1	
448-91 Easy Out Tool (Large)		1	

**439-80**

- 100 pcs of SAE Grease Fittings & Caps packed to a plastic box

THREAD SPEC.	STRAIGHT	45°	90°
1/8"-27 PTF	15	10	10
1/4"-28 SAE-LT	15	10	10
Grease Fitting Caps (Red)		10	
Grease Fitting Caps (Yellow)		10	
Grease Fitting Caps (Black)		10	

439-79

- 100 pcs of Metric Grease Fittings & Caps packed to a plastic box

THREAD SPEC.	STRAIGHT	90°
M6 X 1	15	10
M8 X 1	15	5
M10 X 1	15	10
Grease Fitting Caps (Red)	10	
Grease Fitting Caps (Yellow)	10	
Grease Fitting Caps (Black)	10	

**439-84**

- 60 pcs of SAE Grease Fittings & Couplers packed to a plastic box

THREAD SPEC.	STRAIGHT	45°	90°
1/8"-27 PTF	15	4	4
1/4"-28 SAE-LT	25	4	4
435-02, Prof. 4 Jaw Coupler		1	
435-22, HD 4 Jaw Coupler		1	
435-52, 90° Coupler		1	
448-60, Needle Nose Dispenser		1	

439-83

- 60 pcs of Metric Grease Fittings & Couplers packed to a plastic box

THREAD SPEC.	STRAIGHT	90°
M6 X 1	20	4
M8 X 1	12	4
M10 X 1	12	4
435-02, Prof. 4 Jaw Coupler	1	
435-22, HD 4 Jaw Coupler	1	
435-52, 90° Coupler	1	
448-60, Needle Nose Dispenser	1	

**439-85**

- 65 pcs of SAE Grease Fittings & Assortments packed to a plastic box

THREAD SPEC.	STRAIGHT	45°	90°
1/8"-27 PTF	15	5	5
1/4"-28 SAE-LT	15	5	5
448-90, Easy Out Tool (Small)		1	
448-91, Easy Out Tool (Large)		1	
Grease Fitting Caps (Red)		5	
Grease Fitting Caps (Yellow)		5	
435-02, Professional 4 Jaw Coupler		2	
448-95, Grease Fitting Thread Tester		1	

439-86

- 65 pcs of Metric, SAE Grease Fittings & Assortments packed to a plastic box

THREAD SPEC.	STRAIGHT	90°
1/8"-27 PTF	10	5
1/4"-28 SAE-LT	10	5
M6 X 1	10	
M8 X 1	10	
448-90, Easy Out Tool (Small)	1	
448-91, Easy Out Tool (Large)	1	
Grease Fitting Caps (Red)	5	
Grease Fitting Caps (Yellow)	5	
435-02, Professional 4 Jaw Coupler	2	
448-95, Grease Fitting Thread Tester	1	



Thread Tester

49

GREASING ADAPTORS & ELBOWS

Very useful Steel Fittings used to adapt a threaded fitting to a different size Opening thread.

These are made out of Steel & are zinc plated for increased resistance to corrosion.

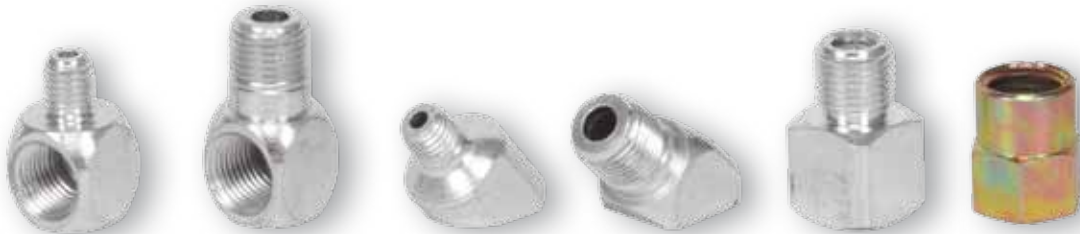

PART NR.	THREADS	BODY	ANGLE	SHANK LENGTH	OVERALL LENGTH
ADAPTORS					
468-00	1/8"-27 (F) x 1/4"-28 (F)	Hex	Straight	1/2"	21/32"
468-01	1/8"-27 (F) x 1/4"-28 (M)	Hex	Straight	1/2"	7/8"
468-02	1/8"-27 (F) x 1/8"-27 (M)	Square	Straight	1/2"	7/8"
ELBOWS					
468-03	1/8"-27 (F) x 1/8"-27 (M)	Square	45°	1/2"	1"
468-04	1/8"-27 (F) x 1/4"-28 (M)	Rounded	45°	1/4"	13/16"
468-05	1/8"-27 (F) x 1/4"-28 (M)	Square	90°	1/2"	13/16"
468-06	1/8"-27 (F) x 1/8"-27 (M)	Square	90°	1/2"	1"



6,000 PSI
(413 BAR)



FOR HAND OPERATED
GREASE GUNS

50

GREASE FITTING
THREAD TESTER

Great tool box accessory to sort out mixed fittings

Aluminum construction with mounting holes

DESIGNED TO CHECK 21 MOST POPULAR THREAD TYPES:

THREAD TYPE	SIZE			
NPT	1/8"	1/4"	3/8"	
METRIC	M6 X 1	M6 X 0.75		
METRIC	M8 X 1	M8 X 1.25		
METRIC	M10 X 1	M10 X 1.5		
BSPT	1/8"	1/4"		
UNF/ANF	1/4"	5/16"	3/8"	
BSW	1/4"	5/16"	1/2"	3/8"
BSF	3/16"	1/4"	5/16"	



PART NR.
448-95

51

GREASE FITTING CAPS

Plastic Caps for Grease fittings are an easy way to keep contaminants out. These additionally help in colour coding the greasing points based on frequency of greasing or type of grease

Designed with an inbuilt collar, these are most convenient in use & fit directly onto the greasing end of the fitting

Made from a special plastic, these adjust to minor variations in fitting head diameter, as well as variations in temperature & practically fit all standard fittings designed for use with jaw type couplers

Available in Black, Red, Yellow, Blue, White & Green as standard with other colours that can be custom manufactured

Sold in packs of 50



PART NR.	COLOUR
467-00	Black
467-01	Red
467-02	Yellow
467-03	Blue
467-04	White
467-05	Green



52

EASY OUT TOOLS

Handy, dual purpose tools for removing worn & broken grease fittings as well as re-tapping holes for installing new grease fittings

Works with straight & angled fittings

Available in small & large sizes for use on almost all threaded fittings



PART NR.	TYPE	OPENS FITTINGS WITH HEX SIZE	TAP RETHEADS
448-90	Small	5/16" & 3/8"	1/4" - 28
448-91	Large	3/8" & 7/16" (11 mm)	1/8" - 27

Key * Best Seller

53

“DRIVE FIT”
GREASE FITTING INSTALLER

Specialty tools for installing straight & angled Drive-Fit Grease fittings into untapped holes

Steel construction in zinc plated finish



PART NR.	FOR FITTING TYPE
448-92	Straight
448-93	Angled

54

GREASE FITTING
UNBLOCKER

Opens clogged grease fittings and loosens hardened grease joints

Excellent for maintaining and protecting bearings, control arms, joints, king pins, etc.

Tool has an all steel construction & is designed to be tapped with a hammer to force a light viscosity oil through the tool into the coupler & finally into the grease joint, breaking up and removing dirt and debris

Built-In Hand Guard for added safety in use

Flexible hose attachment reaches fittings in difficult areas

Comes complete with grease coupler and 2 spare seals for replacing the piston seals as they wear out

PART NR.
448-94



QUICK CONNECTION SYSTEM

*Quick Connect!
Connect or disconnect
with a snap!*

A simple and effective system that renders versatility to Grease Guns

Greasing in inaccessible, difficult to reach areas becomes very convenient with the use of any of the Quick Link accessories. No threads, no screwing or unscrewing, just snap on and use on sealed bearings, U-joints, high-pressure insert fittings and recessed fittings

Ready to use range is detailed in the following pages. Various other combinations, however can be devised based on specific application and need

The system is suitable for use with hand operated grease guns only



STEP 1

Retract sleeve of the quick connect system



STEP 2

Snap on the system by simply "Plugging On" the grease fitting to the coupler



STEP 3

Ensure that the quick connect system is secure



STEP 4

Release the sleeve of the quick connect system. The sleeve automatically slides over the coupler to encase it securely

To disconnect, simply reverse the operation

55

QUICK CONNECT ADAPTORS

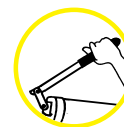

FOR HAND OPERATED
GREASE GUN



1,000 PSI
(69 BAR)

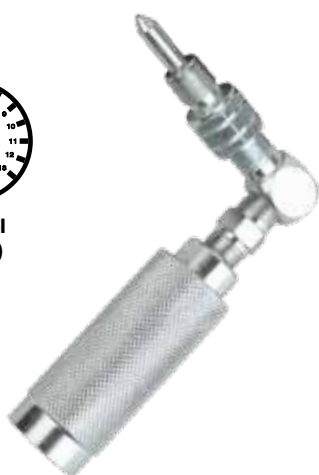

Quick Connect Right Angled Needle Nose Dispenser for dispensing a fine line of grease. The right angled design allows convenient access in shoulders & other confined areas

PART NR.

449-13



6,000 PSI
(413 BAR)



Quick Connect Right angled Grease Coupler Right angle coupler fitted onto the quick disconnect adaptor. For quickly converting regular couplers for greasing fittings with limited access, in low height areas etc. Fits straight onto the grease gun coupler

PART NR.

449-12



1,000 PSI
(69 BAR)



Quick Connect Grease Injector Needle useful for lubricating in very tight spaces such as sealed bearings, universal joints etc. Comes complete with protective plastic holder

PART NR.

449-14

QUICK CONNECT ADAPTORS (continued)

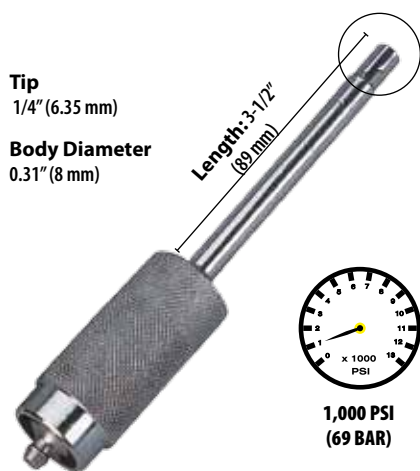

Professional Recessed Lube Adaptor for push on greasing of recessed fittings where obstructions would not permit the use of a regular hydraulic coupler

PART NR.

449-21



Professional 90° Angled Lube Adaptor for greasing inaccessible grease fittings in shoulders and other confined areas

PART NR.

449-22



Professional Narrow Needle Nose Adaptor designed for greasing flush or hard to reach hydraulic type fittings in inaccessible areas

PART NR.

449-20

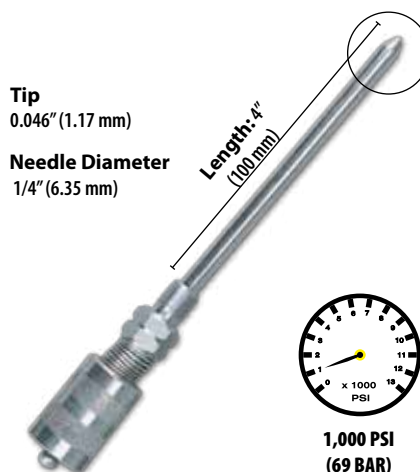

Needle Nose Adaptor
Useful for dispensing a fine line of grease through the needle nose in greasing hard to reach fittings on trucks, vans, and recreational vehicles. Supplied with a small and a large locking sleeve to fit all couplers

PART NR.

449-05



Needle Nose Adaptor
Useful for dispensing a fine line of grease through the needle nose in greasing hard to reach fittings on trucks, vans, and recreational vehicles. Supplied with a small and a large locking sleeve to fit all couplers. Also available with Protective Shroud

PART NR.	THREADS
449-02	1/8" BSPT
449-03	1/8" NPT
449-04	1/8" BSPT (with Shroud)



Professional 360° Swivel Coupler
Useful for effective lubrication of difficult & hard to reach grease fittings. Coupler swivels in full 360° circle & can be locked at intervals of 45°

PART NR.

449-11

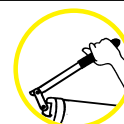

**FOR HAND OPERATED
GREASE GUN**

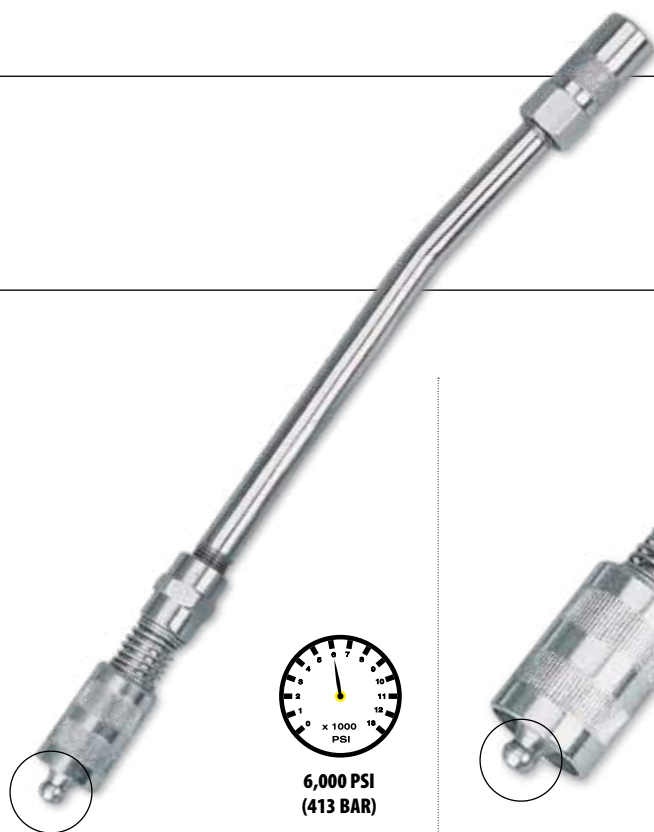

**6,000 PSI
(413 BAR)**

Coupler to Coupler Extension

6" (150 mm) angled delivery tube and 4 jaw professional coupler fitted onto the quick disconnect adaptor. Serves as an extra length extension on grease guns. Fits straight onto the grease gun coupler

PART NR.

449-06



**3,000 PSI
(207 BAR)**

Jaw Type Coupler to Button Head Coupler

Push on button head coupler fitted onto the quick disconnect adaptor. For quick conversion of jaw type couplers to button head coupler for use on 5/8" (16 mm) button head grease fittings directly. Fits straight onto the grease gun coupler

PART NR.

449-07



**1,000 PSI
(69 BAR)**

Regular Coupler to Right Angled Coupler

Right angle coupler fitted onto the quick disconnect adaptor. For quickly converting regular couplers for greasing fittings with limited access, in low height areas etc. Fits straight onto the grease gun coupler

PART NR.

449-08



**1,000 PSI
(69 BAR)**

Jaw type Coupler to Seal Off Dispenser

Seal Off Dispenser fitted onto the quick disconnect adaptor. For quickly converting regular couplers for lubricating automobiles with grease plugs etc. Fits straight onto the grease gun coupler

PART NR.

449-09

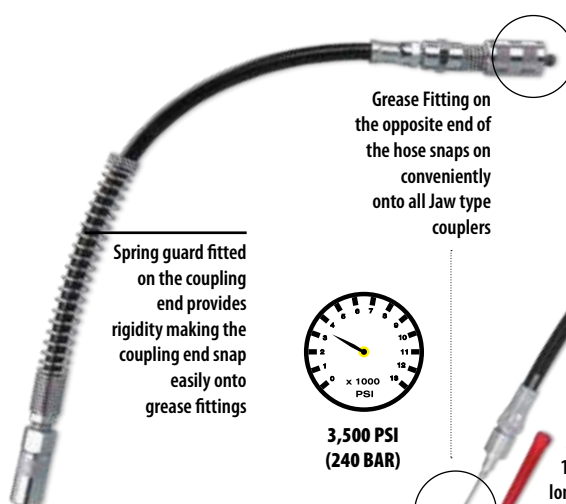

Spring guard fitted on the coupling end provides rigidity making the coupling end snap easily onto grease fittings



**3,500 PSI
(240 BAR)**

Quick Connect Hose

The Quick Connect Hose converts steel extension coupler assembly on grease guns to a flexible hose and allows the gun to be used for greasing hard to reach fittings. Overall length: 16" (410 mm)

PART NR.

449-10

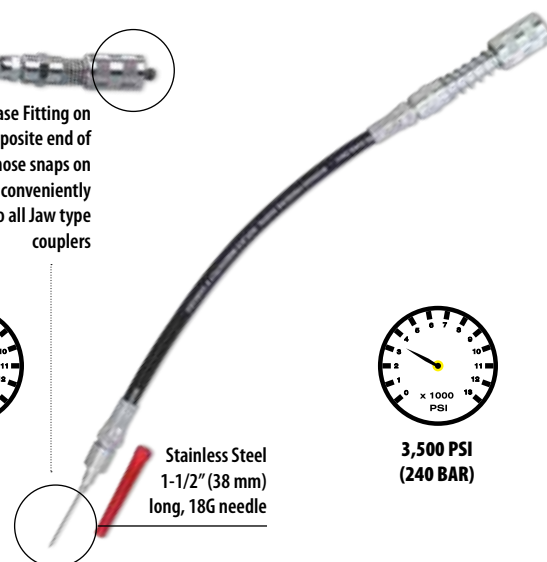

Grease Fitting on the opposite end of the hose snaps on conveniently onto all Jaw type couplers



**3,500 PSI
(240 BAR)**

Quick Connect Grease Hose & Needle

The Quick Connect Hose converts jaw type coupler on grease guns to a Grease Injector needle for greasing in very tight spaces such as universal joints & sealed bearings. Hose fitted onto the needle enables access onto hard to reach fittings as well as makes it easy to handle the needle without the risk of injury. Overall length: 15½" (393 mm)

PART NR.

448-75

56

QUICK DISCONNECT ADAPTOR



Adaptor with grease fitting on one end and male threads on the other

Threaded end can be screwed onto any dispenser with 1/8" female threads, thus allowing for quick connect greasing applications

Supplied with a small and large locking sleeve to fit most couplers

PART NR.	THREADS
449-00	1/8" BSPT
449-01	1/8" NPT

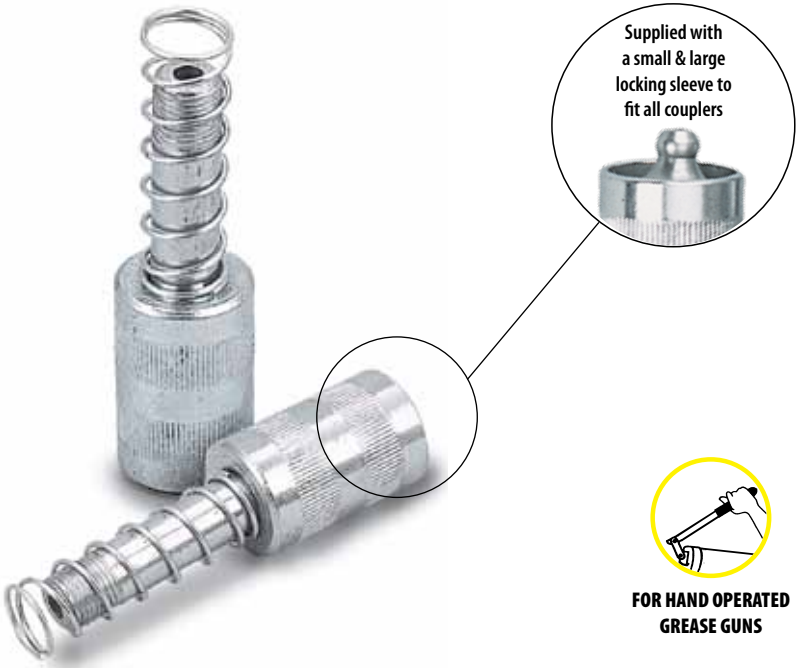

57

EZEE LUBE KIT



The Ezee-Lube kit comprises of a range of quick connect lube accessories. Useful for even the most difficult greasing jobs. The constituents convert any grease gun fitted with jaw type coupler into special application greasing. This helps in effective lubrication of grease plugs, sealed bearings, push on greasing of recessed fittings or fittings in shoulders, low height areas or an extension for reaching those "deep" places

PART NR.
* 449-50

Key * Best Seller



58

COMPOSITE AIR OPERATED GREASE RATIO PUMPS 50:1



INDUSTRIAL



AUTOMOTIVE

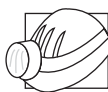

MINING

Compact Air Operated 50:1 Grease Ratio Pump

Operates off most small compressors with size as small as 0.08 cubic meter / minute (3 cfm)

Ideal for applications having continuous need for high pressure grease in Industry, Workshops, Farm etc.

Zinc construction makes them suitable for mining applications

2.83" (72 mm) dia. air motor

Grease strainer at suction tube inlet, ensures clean grease to the bearing

Non corroding air motor design allows the pump to be used without an air line lubricator

Fitted with a pressure release valve- prevents both the pump & system against damage created by excessive pressure, possibly due to thermal expansion

Comes complete with drum cover, rubber lined follower plate, 7' (84") of high pressure grease hose, Z swivel & professional grease control valve

WETTED COMPONENTS

Zinc, hard chrome plated steel, brass, nitrile & polyurethane rubber

RECOMMENDED USE

With light and self collapsing grease up to NLGI No. 2

Control Valve threaded
1/4" (F) at inlet and
1/8" (F) at outlet

454-00

For use with 25-50 lbs
/ 20 kg / 5 gal. pails.
Suction tube length
17.5/16" (440 mm)

Z swivel threaded
1/4" NPT (M) x
1/4" NPT (F)

443-46

Available as spare:
84" high pressure hose
threaded 1/4" NPT (M)

SPECIFICATIONS

Working Pressure	4 – 10 BAR (60 to 150 PSI)
Maximum Air Pressure	10 BAR (150 PSI)
Maximum Outlet Pressure	500 BAR (7500 PSI)
Air Inlet Connection	1/4" NPT (F)
Pump Outlet Connection	1/4" NPT (F)
Air Consumption	270 lt / min (72 GPM)
Grease Output (NLGI No. 2 Grease)	0.460 kg / min (1 lb / min)
Noise Level	85 db



WARNING

Pump must be supplied with clean & dry compressed air via an FR unit

PART NR.	FITS	DRUM COVER DIAMETER	FOLLOWER PLATE DIMENSIONS		
			O.D. STEEL END	O.D. PLATE	I.D. GROMMET
454-00	25-50 lb / 20 kg / 5 gal. pails	12" (310 mm)	9.1/2" (241 mm)	11.11/32" (288 mm)	1.08" (27.5 mm)
454-01	120 lb / 50 kg / 16gal pails	15" (381 mm)	12.11/16" (322 mm)	15" (380 mm)	1.08" (27.5 mm)
454-02	400 lbs / 180 kg / 55 gal pails	24-1/2" (622 mm)	21-5/8" (550 mm)	23-11/16" (602 mm)	1.08" (27.5 mm)

59

AIR OPERATED GREASE RATIO PUMPS 50:1

CE



INDUSTRIAL



AUTOMOTIVE

World-class Industrial High Pressure Grease pumps with guaranteed performance & hassle free operation

Pump dispenses Grease at pressures upto 50 times the Air inlet pressure

Designed to work in tough conditions - these are ideal for use in Industry, workshop, farm, construction or as part of the Mobile Grease system

All metal construction, fully CNC machined with hardened wear resistant moving parts

Reciprocating piston operated 2-1/2" (63 mm) dia. air motor

Fitted with strainer at suction tube inlet for clean grease to the bearing

Supplied complete with Drum Cover, rubber lined follower plate, 7' (84") of high pressure grease hose, Z swivel & professional grease control valve

Portable version available with built-in steel drum, complete with wheels & pull handle

WETTED COMPONENTS

Steel, Brass, Aluminium, Polyurethane & Nitrile Rubber

RECOMMENDED USE

With light and self collapsing grease up to NLGI No. 2

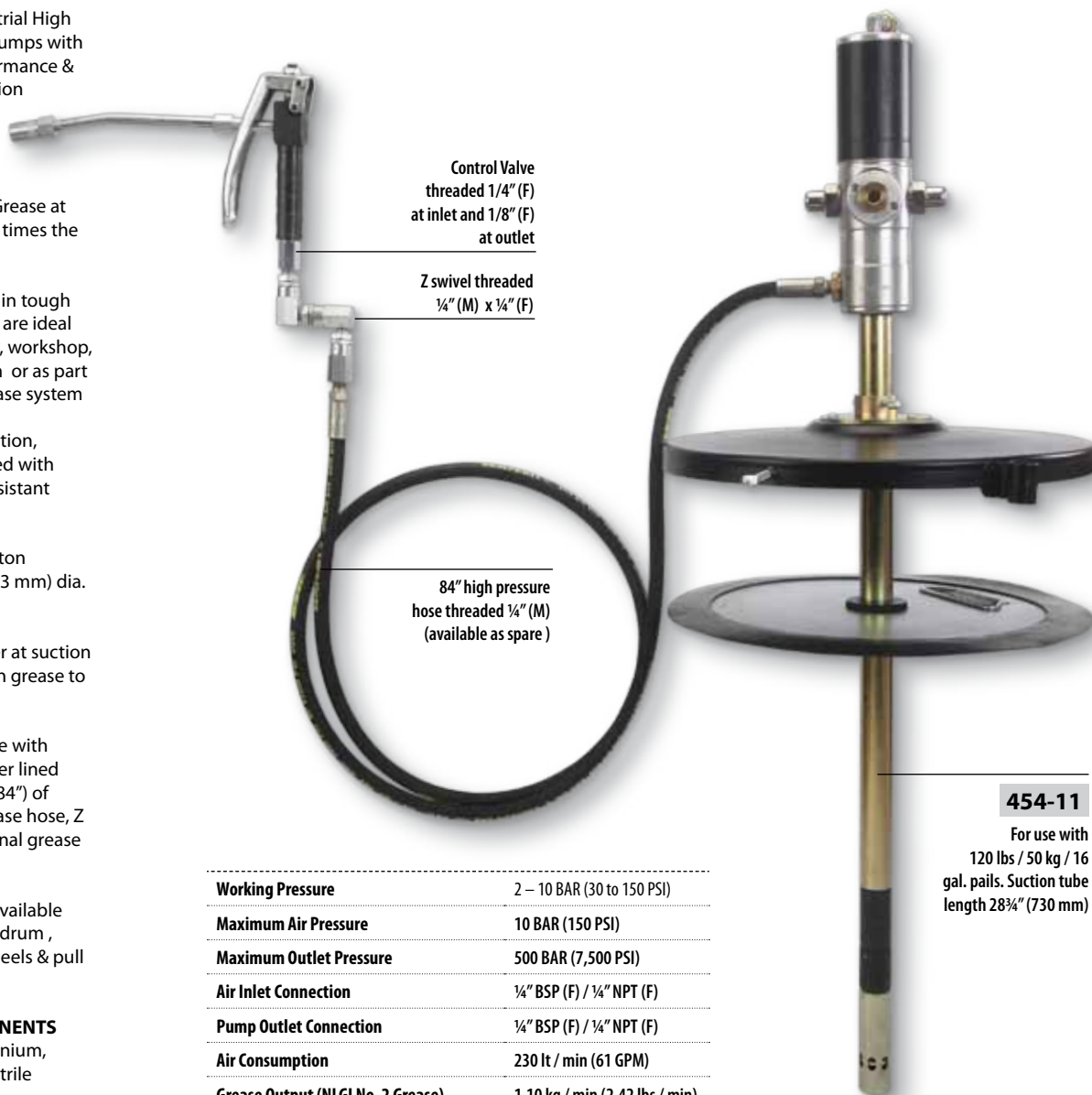

Control Valve threaded 1/4" (F) at inlet and 1/8" (F) at outlet

Z swivel threaded 1/4" (M) x 1/4" (F)

84" high pressure hose threaded 1/4" (M) (available as spare)

454-11

For use with 120 lbs / 50 kg / 16 gal. pails. Suction tube length 28 3/4" (730 mm)

Working Pressure	2 – 10 BAR (30 to 150 PSI)
Maximum Air Pressure	10 BAR (150 PSI)
Maximum Outlet Pressure	500 BAR (7,500 PSI)
Air Inlet Connection	1/4" BSP (F) / 1/4" NPT (F)
Pump Outlet Connection	1/4" BSP (F) / 1/4" NPT (F)
Air Consumption	230 lt / min (61 GPM)
Grease Output (NLGI No. 2 Grease)	1.10 kg / min (2.42 lbs / min)
Noise Level	81 db

PART NR.	PART NR.	FITS	DRUM COVER DIAMETER	FOLLOWER PLATE DIMENSIONS		
BSP THREADS	NPT THREADS			O.D. STEEL END	O.D. PLATE	I.D. GROMET
454-09	----	12.5 kg drums	11" (284 mm)	9-3/64" (230 mm)	10-1/8" (257 mm)	1.16" (29.5 mm)
454-10	454-15	25-50 lb / 5 gal. / 20-30 kg pails	12" (310 mm)	9-1/2" (241 mm)	11-11/32" (288 mm)	1.16" (29.5 mm)
454-11	* 454-16	120 lb / 16 gal. / 50-60 kg pails	15" (381 mm)	12-11/16" (322 mm)	15" (380 mm)	1.16" (29.5 mm)
* 454-12	454-17	400lb / 180 kg drums	24.1/2" (612 mm)	21-5/8" (550 mm)	23-11/16" (602 mm)	1.16" (29.5 mm)

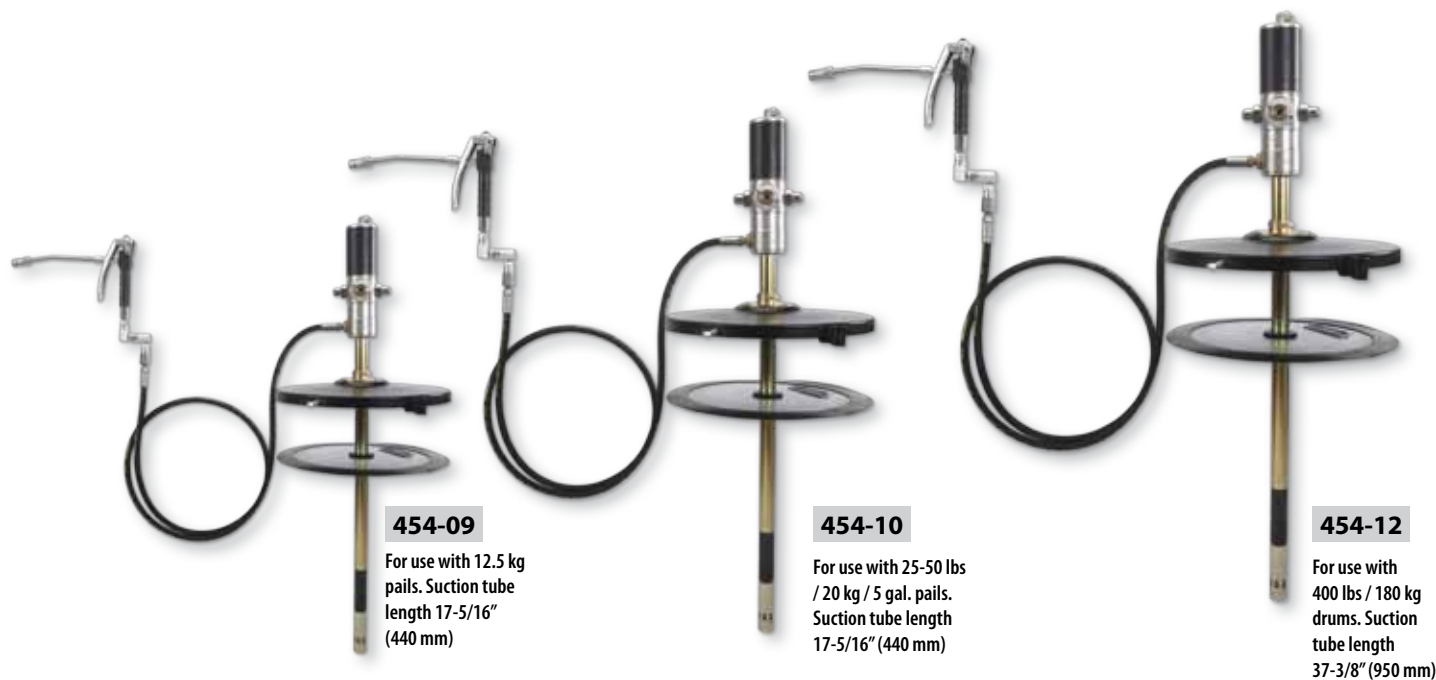

454-09

For use with 12.5 kg pails. Suction tube length 17-5/16\" (440 mm)

454-10

For use with 25-50 lbs / 20 kg / 5 gal. pails. Suction tube length 17-5/16\" (440 mm)

454-12

For use with 400 lbs / 180 kg drums. Suction tube length 37-3/8\" (950 mm)

454-40

Portable Grease Pump with built-in 15 kg Grease Bucket

454-36

Portable Grease Pump with built-in 30 kg Grease Bucket

454-37

Portable Grease Pump with built-in 50 kg Grease Bucket



PART NR.	BUCKET CAPACITY
* 454-40	15 kg
454-36	30 kg
454-37	50 kg

Key * Best Seller

! WARNING

Pump must be supplied with clean & dry compressed air via an FRL unit

60

GREASE CONTROL VALVES -
PROFESSIONAL

- Premium quality Grease Control valve, for use with air operated grease pumps
- Provides continuous grease flow, with trigger fully pressed
- Steel construction, provides durability & longevity
- Ergonomically designed pistol handle
- Available as valve only, or fitted with 360° Z Swivel
- Comes complete with 6" steel extension & heavy duty coupler
- Available in a choice of inlet thread sizes

! WARNING

Skin Injection Hazard.
Keep away from nozzle

CAUTION
The gun is continuous action. Be careful not to over lubricate.



PART NR.	INLET THREAD SPECIFICATION	OUTLET THREAD SPECIFICATION
VALVE ONLY		
434-00	1/8" BSPT (F)	1/8" BSPT (F)
* 434-01	1/4" BSPT (F)	1/8" BSPT (F)
434-02	1/4" BSPT (F)	M10 x 1 (F)
434-03	1/8" NPTF (F)	1/8" NPT (F)
* 434-04	1/4" NPTF (F)	1/8" NPT (F)
VALVE FITTED WITH Z SWIVEL		
* 434-20	1/4" BSPT (F)	1/8" BSPT (F)
434-21	1/4" BSPT (M)	1/8" BSPT (F)
434-22	1/4" BSPT (F)	M10 x 1 (F)
* 434-23	1/4" NPTF (F)	1/8" NPT (F)
434-24	1/2" -27 NS (M)	1/8" NPT (F)

Key * Best Seller



MAX. WORKING PRESSURE
7,500 PSI (517 BAR)

61

GREASE CONTROL VALVES -
BOOSTER

Heavy Duty Grease control valve with built-in pressure boost mechanism. Provides continuous flow with pistol handle fully pressed

Pressure boost achieved through repeated actuation of the pistol handle. Boosts line pressure from 6,000 PSI (400 BAR) to 10,000 PSI (690 BAR); extremely useful to unblock frozen grease fittings

Heavy Duty steel construction, provides durability & longevity

Ergonomically designed pistol handle

Available as valve only, or fitted with 360° Z Swivel

Comes complete with 6" (150 mm) steel extension & coupler

Available in a choice of inlet thread sizes

! WARNING

Skin Injection Hazard.
Keep away from nozzle

CAUTION
The gun is continuous action. Be careful not to over lubricate.



MAX. WORKING PRESSURE
10,000 PSI (690 BAR)

434-54

Booster Grease control valve. Complete with Heavy Duty 4 Jaw Coupler with ball check

**434-68**

Booster Grease control valve with pressure relief valve on the outlet. Opening the relief valve removes high pressure from the coupler enabling easy coupler disconnection from the zerk fitting. Complete with 3 Jaw Professional coupler without ball check

PART NR.	INLET THREAD SPECIFICATION	OUTLET THREAD SPECIFICATION
CONTROL HANDLE		
434-50	1/8" BSPT (F)	1/8" BSPT (F)
* 434-51	1/4" BSPT (F)	1/8" BSPT (F)
434-52	1/4" BSPT (F)	M10 x 1 (F)
434-53	1/8" NPTF (F)	1/8" NPT (F)
* 434-54	1/4" NPTF (F)	1/8" NPT (F)
CONTROL HANDLE WITH Z-SWIVEL		
* 434-70	1/4" BSPT (F)	1/8" BSPT (F)
434-71	1/4" BSPT (M)	1/8" BSPT (F)
* 434-72	1/4" BSPT (F)	M10 x 1 (F)
434-73	1/4" NPTF (F)	1/8" NPT (F)
434-74	1/2" -27 NS (M)	1/8" NPT (F)

PART NR.	INLET THREAD SPECIFICATION	OUTLET THREAD SPECIFICATION
CONTROL HANDLE WITH PRESSURE RELIEF VALVE		
434-60	1/8" BSPT (F)	1/8" BSPT (F)
434-61	1/4" BSPT (F)	1/8" BSPT (F)
434-62	1/4" BSPT (F)	M10 x 1 (F)
434-63	1/8" NPTF (F)	1/8" NPT (F)
434-64	1/4" NPTF (F)	1/8" NPT (F)
CONTROL HANDLE WITH PRESSURE RELIEF VALVE & Z SWIVEL		
434-65	1/4" BSPT (F)	1/8" BSPT (F)
434-66	1/4" BSPT (M)	1/8" BSPT (F)
434-67	1/4" BSPT (F)	M10 x 1 (F)
434-68	1/4" NPTF (F)	1/8" NPT (F)
434-69	1/2" -27 NS (M)	1/8" NPT (F)

Key * Best Seller

62

GREASE CONTROL VALVE
METERED



Premium quality Grease Control valve, for use with air operated grease pumps

Built-In High Accuracy Digital Grease Meter for dispensing exact amount of grease

Ability to measure amount of grease dispensed prevents both over & under lubrication & is invaluable in saving bearing failures

Provides continuous grease flow, with trigger fully pressed

Steel construction, provides durability & longevity. Meter uses oval gear technology

Ergonomically designed pistol handle

Comes complete with 6" steel extension & heavy duty coupler



MAX. WORKING PRESSURE
7,500 PSI (517 BAR)

! WARNING

Skin Injection Hazard.
Keep away from nozzle

CAUTION
The gun is continuous action. Be careful not to over lubricate.

TEMPERATURE



Working Temperature Range
-10°C to 60°C (14°F to 140°F)

Oval gear mechanism

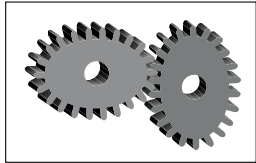

434-15



456-21

Grease meter available as spare for in-line applications. Measures in both kg & lbs

SPECIFICATIONS

Control Valve Type	Continuous Flow
Meter Type	Digital Oval Gear
Grease Flow	0.1 to 2.5 kg / min (0.2 - 5.5 lb / min)
Max. Working Pressure	7,500 PSI (517 BAR)
Unit of Measurement	Kg / gms / oz. / lbs
Resolution	0.10 gms / 0.10 oz.
Accuracy	+/- 3%
Resettable Batch Total	9,999
Cumulative Total	999999
Battery Type	2 x 1.5V Size N

PART NR.	DESCRIPTION	THREAD SPECIFICATION
434-15	Meter Fitted to Grease Control Valve	Inlet: 1/4" BSPT (F)
434-16	Meter Fitted to Grease Control Valve	Inlet: 1/4" NPTF (F)
456-21	In-Line Grease Meter	Inlet/Outlet: 1/8" NPT (F)

63

HIGH PRESSURE
GREASE SWIVELS

Installed between the delivery hose & grease control valve, swivels permit easy handling of control valves and prevent damage to hose caused by twisting

Swivels have a heavy duty steel construction with ball bearings for smooth operation and free unrestricted movement

The swiveling joints are hardened for durability & wear resistance

Available in three forms: Straight, 90° & Z-360°, in varying thread specifications. Other thread sizes can be made on request



MAX. WORKING PRESSURE
6,000 PSI (413 BAR)

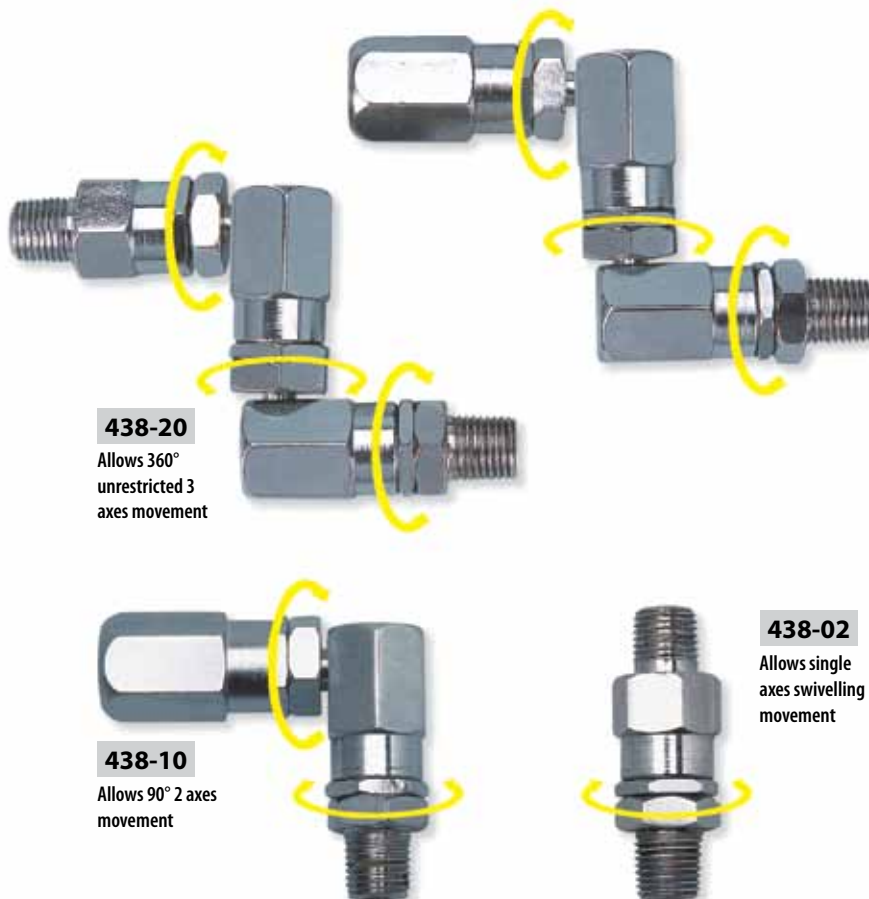

438-20

Allows 360°
unrestricted 3
axes movement

438-10

Allows 90° 2 axes
movement

438-02

Allows single
axes swivelling
movement

PART NR.	THREAD SPECIFICATION	
STRAIGHT SWIVELS		
438-00	1/4" BSPT (F)	1/4" BSPT (M)
438-01	1/4" BSPT (F)	1/8" BSPT (M)
438-02	1/8" NPTF (M)	1/8" NPTF (M)
438-03	1/8" NPTF (F)	1/8" NPTF (M)
438-04	1/4" NPTF (M)	1/2" - 27 NS (M)
90° SWIVELS		
438-10	1/4" BSPT (F)	1/4" BSPT (M)
438-11	1/4" BSPT (F)	1/8" BSPT (M)
438-12	1/8" NPTF (M)	1/8" NPTF (M)
438-13	1/8" NPTF (F)	1/8" NPTF (M)
438-14	1/4" NPTF (M)	1/2" - 27 NS (M)
Z - 360° SWIVELS		
438-20	1/4" BSPT (M)	1/4" BSPT (M)
* 438-21	1/4" BSPT (F)	1/4" BSPT (M)
* 438-22	1/4" BSPT (F)	1/8" BSPT (M)
* 438-23	1/4" NPTF (F)	1/8" NPTF (M)
* 438-24	1/4" NPTF (F)	1/4" NPTF (M)
438-25	1/4" NPTF (M)	1/2" - 27 NS (M)

Key * Best Seller

360° Z Swivel

Allows for convenient movement of the control valve & prevents the high pressure hose from kinking





FOOT OPERATED GREASE PUMP

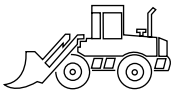

CONSTRUCTION



AUTOMOTIVE



AGRICULTURE

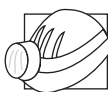

MINING

High Pressure Portable Grease Pump for quick effortless greasing in everyday lubrication such as greasing of excavators & other earth moving equipment, agricultural equipment, automotive etc.

Hands free operation
Pump operates using the Foot Lever, which greatly reduces effort & allows high pressure greasing with highest comfort

Can be operated by hand when under low machinery

Economical
Pump is operated by a single person & uses low cost bulk grease

Designed with all moving parts submerged in the same grease which needs to be pumped, thereby staying lubricated at all times

Moving parts create wave action in grease, auto removing air pockets & eliminating the use of a follower plate

Pump delivers 2 gms of grease per stroke & develops upto 8,700 PSI (600 BAR)

Works with NLGI 1 & 2 Greases



DELIVERS

Upto 2 gms / stroke

Upto 1 oz. / 15 strokes



Lift handle

Steel Drum Cover

Steel Bucket with 10 kg (22 lbs.) capacity

Nozzle Holder

Pistol handle fitted with Steel Grease Extension & heavy duty coupler

Includes 2m x 1/4" ID high pressure rubber hose

Foot Lever

Rubber Pads



NOTE
Pump is 100% pressure tested using non food grade grease. New pumps would have some test grease inside, confirming that the pump has been factory tested

PART NR.	BUCKET CAPACITY
442-56	10 kgs (22 lbs.)

65

PORTABLE GREASING SYSTEM

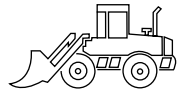

CONSTRUCTION



AUTOMOTIVE



AGRICULTURE

Fully Portable & single person operation manual greasing system designed for volume greasing in workshop environments, site applications, on a pick-up truck, tractor, earth moving equipment etc.

Pump is operated by foot press of the spring loaded system. The hose gets charged with grease, which can then be dispensed through the Super Gun fitted at the end of the hose. A single charge provides upto 30 shots of grease

Aluminium die cast super gun develops greasing pressure and has high pressure & high volume settings, actuated through a simple switch. High pressure setting dispenses 0.45 gm of grease in each shot at 10,000 PSI. High volume setting dispenses 1.25 gms per shot

High pressure feature is very useful to open blocked grease fittings

Pump assembly is fully sealed to prevent contamination

Pump comes complete with drum cover, rubber lined follower plate, premium 1/2" ID high pressure hose, Super gun fitted with steel extension & coupler and 11 lb. (5 kg.) plastic grease bucket

WETTED COMPONENTS

Aluminum, Steel, Brass,
Polyurethane & Nitrile Rubber

RECOMMENDED USE

For Grease up to and including NLGI
No. 2

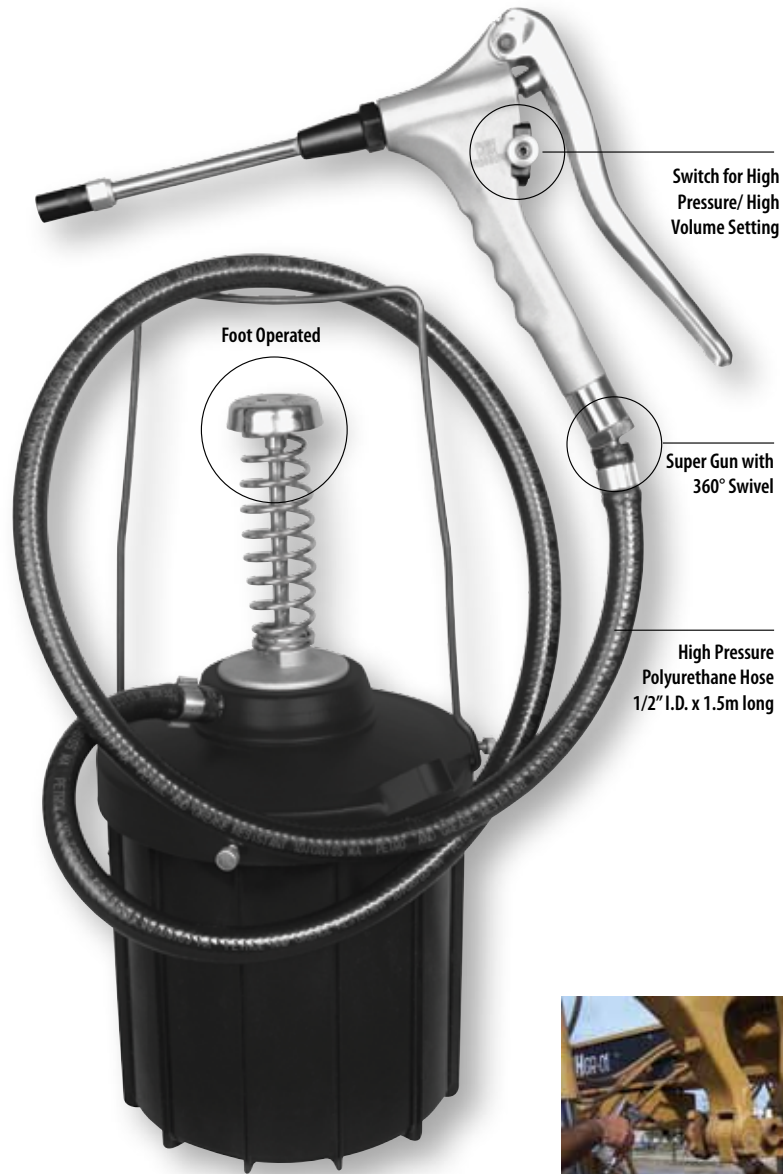

Common sight
on construction
equipment requiring
high volume routine
greasing

DELIVERS

Upto 1.25 gm / stroke
on high volume setting



10,000 PSI
(690 BAR)

PART NR.	BUCKET CAPACITY	PUMP LENGTH BELOW DRUM COVER	DRUM COVER DIAMETER	FOLLOWER PLATE DIMENSIONS		HOSE LENGTH
				O.D. STEEL END	O.D. PLATE	
* 442-53	5 kg / 11 lb.	7-3/4" (197 mm)	8-1/2" (216 mm)	6-3/4" (171 mm)	8-1/8" (206 mm)	1.5 m

Key * Best Seller

66

BUCKET GREASERS



Volume Grease Pump designed for quick effortless greasing in applications requiring everyday lubrication such as greasing of excavators & other earth moving equipment, agricultural equipment, automotive applications etc.

The Pump delivers upto 9 gms (0.30 oz.) of Grease per stroke which is twice the amount of grease discharge by any other pump. Fully CNC machined to very close tolerances, the pump develops pressure upto 4,000 PSI (275 BAR)

Whereas most pumps work only with light Greases, the VGP series pumps work equally well with NLGI 1 , 2 & 3 Greases

WETTED COMPONENTS
Steel, Aluminum, Brass & Nitrile Rubber

RECOMMENDED USE
For Grease up to and including NLGI 3

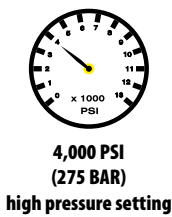

DELIVERS

Upto 9 gms / stroke (0.30 oz. / stroke)
high volume setting

PART NR.		BUCKET CAPACITY
WITHOUT WHEELS	WITH WHEELS	
442-84	442-94	6 kg (13 lb.)
* 442-85	442-95	10 kg (22 lb.)
442-86	442-97	15 kg (33 lb.)
----	442-98	20 kg (44 lb.)

Key * Best Seller



VARIABLE HANDLE SETTING

High Pressure Setting
Develops 4,000 PSI with grease discharge upto 4 gms per stroke

Medium Pressure Medium Volume Setting
Develops 3,000 PSI with grease discharge upto 7gms per stroke

High Volume Setting
Develops 2,000 PSI with grease discharge of over 9 gms per stroke. Also useful for bulk filling grease guns



442-84

(Without wheels)
Capacity : 6 kgs / 13lbs.



442-94

(With wheels)
Capacity : 6 kgs / 13lbs.



442-95

(With wheels)
Capacity : 10 kgs / 22lbs.



442-86

(Without wheels)
Capacity : 15 kgs / 33lbs.



442-97

(With wheels)
Capacity : 15 kgs / 33lbs.



442-98

(With wheels)
Capacity : 20 kgs / 44lbs.



GREASE FILLER PUMP - PROFESSIONAL



Industry's # 1 bulk grease filling pump with extra heavy duty construction & discharge almost twice as much as any other filler pump

Ideal workshop complement combining economical bulk grease purchasing with the portability of a hand operated grease pump

Suitable for bulk filling grease guns, as well as transfer of grease from large to small containers

Solid cast aluminum pump head, ergonomic steel pump handle, solid steel drum cover with lift handle & rubber lined follower plate

Brass piston rings for minimal wear

Variable handle setting for increased convenience in use with light & heavy greases

Fully sealed to prevent contamination

RECOMMENDED USE
For grease up to and including NLGI 3



DELIVERS

54 gms (1.9 OZ.) / stroke

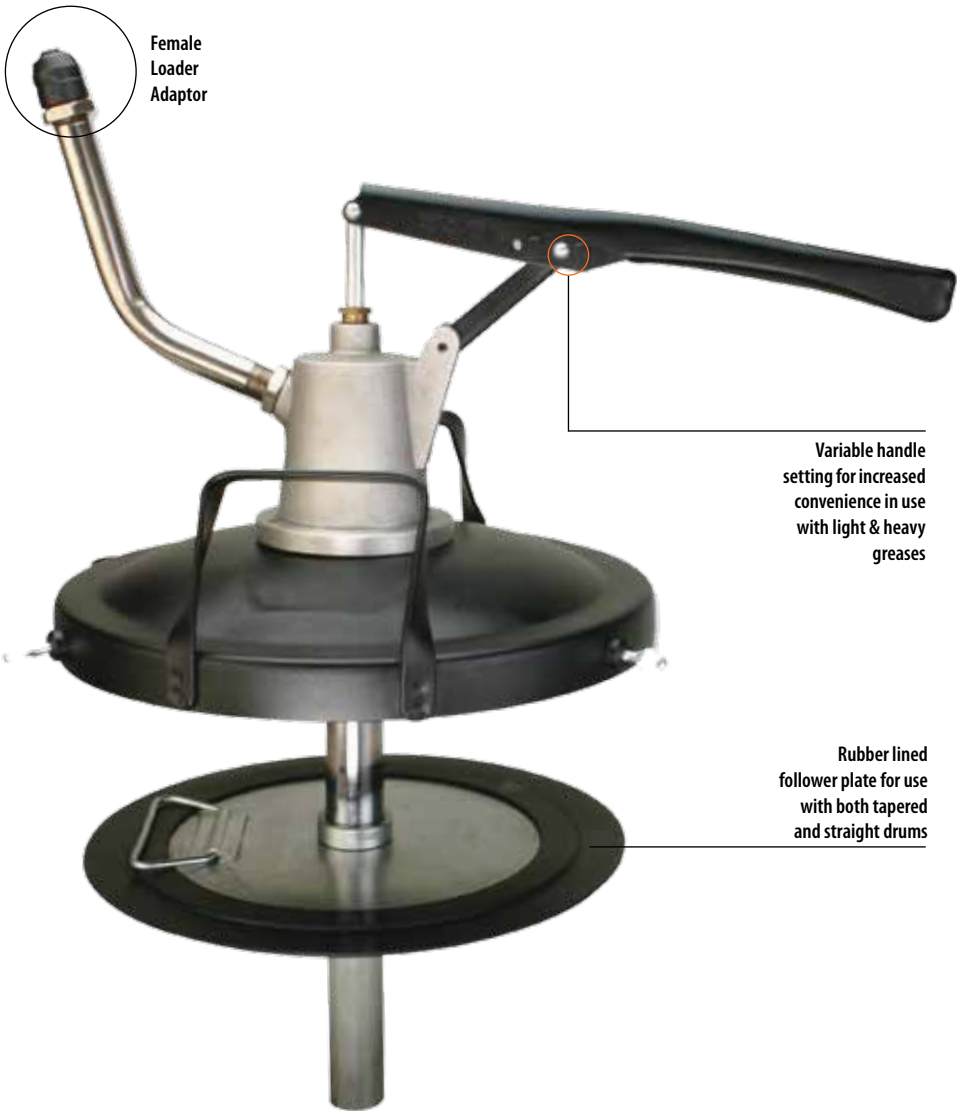

PART NR.	PAIL CAPACITY	PUMP LENGTH BELOW DRUM COVER	DRUM COVER DIAMETER	TYPE OF FOLLOWER PLATE	FOLLOWER PLATE DIMENSIONS			FEMALE LOADER ADAPTOR
					O.D. STEEL END	O.D. PLATE	I.D. PLATE	
442-16	20 kg	12" (310)	12" (310)	Rubber Lining	9-3/8" (238 mm)	11-1/2" (293 mm)	1-1/4" (31.4 mm)	Suitable for 9 mm straight loader fittings
442-15	5 gal. (20-50 lbs)	12" (310)	12" (310)	Rubber Lining	9-3/8" (238 mm)	11-1/2" (293 mm)	1-1/4" (31.4 mm)	Suitable for 0.58" American tapered loader fittings

68

GREASE FILLER PUMPS



INDUSTRIAL



AUTOMOTIVE



AGRICULTURE

Easy to use Grease filling solution to load bulk or combination grease guns from bulk grease pails

No mess or waste. Full economy in buying bulk grease

Complete unit includes zinc plated pump with zinc die cast pump head and cast aluminum adjusting flange, drum cover, follower plate & female loader fitting

Select models include follower plate with rubber lining for use with tapered drums

Available with a choice of Female loader adaptors:
Regular for use with American Tapered 0.58" (14.7 mm) male loader fittings or Universal which adapts to both European Straight (9 mm) and American Tapered 0.58" (14.7 mm) male loader fittings

RECOMMENDED USE

For Light & self Collapsing Grease up to and including NLGI 2



442-12



442-10

DELIVERS

Upto 28 gms (1 oz.) / stroke



USEFUL TIPS!

Prime pump when using for the first time. Pour 30 ml. oil in to the pump outlet & operate lever handle till grease starts dispensing. Never exert undue pressure on the lever handle

PART NR.	PAIL CAPACITY	PUMP LENGTH	DRUM COVER DIAMETER	TYPE OF FOLLOWER PLATE	FOLLOWER PLATE DIMENSIONS			FEMALE LOADER ADAPTOR
					O.D. STEEL END	O.D. PLATE	I.D. GROMMET	
442-00	12.5 kg	18" (457 mm)	287 mm	Rubber Lining	230 mm	272 mm	38 mm	Universal
442-10	25-50 lb / 5gal.	18" (457 mm)	12" (310 mm)	Steel	-	11" (280 mm)	1.1/2" (38 mm)	American
442-11	25-50 lb / 5gal. / 20 kg	18" (457 mm)	12" (310 mm)	Rubber Lining	9.1/2" (241 mm)	11-11/32" (288 mm)	1.1/2" (38 mm)	American
* 442-12	25-50 lb / 5gal. / 20 kg	18" (457 mm)	12" (310 mm)	Rubber Lining	9.1/2" (241 mm)	11-11/32" (288 mm)	1.1/2" (38 mm)	Universal
442-22	120 lb. / 50 kg	30" (760 mm)	15" (381 mm)	Steel	-	13-5/8" (346 mm)	1.1/2" (38 mm)	American
442-20	120lb. / 50 kg	30" (760 mm)	15" (381 mm)	Rubber Lining	12-11/16" (322 mm)	15" (380 mm)	1.1/2" (38 mm)	American
442-21	120lb. / 50 kg	30" (760 mm)	15" (381 mm)	Rubber Lining	12.11/16" (322 mm)	15" (380 mm)	1.1/2" (38 mm)	Universal

Key * Best Seller

69

HIGH PRESSURE GREASE PUMPS



INDUSTRIAL



AUTOMOTIVE



AGRICULTURE



CONSTRUCTION

An easy & portable high pressure hand operated grease pump

Provides high pressure greasing, where power is not available or when an air operated grease pump cannot be afforded

Useful for clean greasing of machinery, equipment, trucks & cars

Pump has steel construction with aluminum cast head & solid steel pumping chamber

Comes complete with Lift handle, Drum Cover, Rubber Lining Follower plate, 48" (1220 mm) flexible grease hose fitted with professional 4 jaw coupler. Model HPG-10 additionally includes a 10 kg (22 lb.) steel Grease Bucket



DELIVERS

1.5 gms / stroke
(1 oz. in 19 strokes)



3,500 PSI
(240 BAR)

Lift Handle



443-45

48" flexible high pressure hose with coupler (available as spare)



USEFUL TIPS!

Prime pump when using for the first time. Pour 30 ml. oil in to the pump outlet & operate lever handle till grease starts dispensing.

442-30

For use with 25-50 lb/20 kg. grease pails



442-31

For use with 12.5 kg Grease Buckets popular in the United Kingdom



442-46

Includes 10kg (22 lb.) steel Grease Bucket with foot rest

PART NR.	PAIL CAPACITY	PUMP LENGTH BELOW DRUM COVER	DRUM COVER DIAMETER	TYPE OF FOLLOWER PLATE	FOLLOWER PLATE DIMENSIONS		
					O.D. STEEL END	O.D. PLATE	I.D. GROMMET
* 442-31	12.5 kg	315 mm	287 mm	Rubber Lining	230 mm	272 mm	25 mm
442-30	25-50 lb / 20 kg	13.11/16" (348 mm)	12" (310 mm)	Rubber Lining	9.1/2"	11.11/32"	1"
442-46	10 kg	367 mm	224 mm	Rubber Lining	195 mm	225 mm	25 mm

Key * Best Seller

70

FOLLOWER PLATES

A range of follower plates, for use with Grease pumps

Follower plates eliminate channeling & air pockets, keep lubricants from contamination & assist in pumping all of the lubricant from containers

443-20**All Steel Follower Plates**

These are made out of plated sheet metal. The rubber grommet fitted on the centre of the follower plate is slid on the pump suction tube. Used commonly as a low cost alternative with straight grease pails

**443-22****Rubber Lining Follower Plates**

These have a metal main body, with a grease resistant rubber lining. The rubber lining is very effective in wiping grease from container walls and eliminating any air pockets. A steel handle is welded onto the plate for easy removal of the plate, after the grease container is emptied. The rubber grommet fitted on the centre of the follower plate is slid on the pump suction tube. Useful for both straight & tapered grease pails

**443-23**

PART NR.	PAIL CAPACITY	OUTER DIA. OF RIGID STEEL END OF FOLLOWER PLATE	OUTER DIA. OF FOLLOWER PLATE	INNER DIA. OF GROMMET RUBBER	FOR USE WITH PROLUBE PUMPS
ALL STEEL FOLLOWER PLATES					
443-20	25-50 lb / 5gal.	11" (280 mm)	11" (280 mm)	1.1/2" (38 mm)	442-10
443-29	120 lb / 16 gal. / 50 kg	13-5/8" (346 mm)	13-5/8" (346 mm)	1.1/2" (38 mm)	442-22
RUBBER LINING FOLLOWER PLATES					
478-20	15 kg	195 mm	225 mm	29 mm	454-40
443-21	12.5 kg	230 mm	272 mm	38 mm	442-00
443-34	12.5 kg	230 mm	272 mm	25 mm	442-31
478-21	12.5 kg	230 mm	272 mm	1.16" (29.5 mm)	454-09
443-22	25-50 lb / 5gal. / 20 kg	9-1/2" (241 mm)	11-11/32" (288 mm)	1-1/2" (38 mm)	442-11
443-23	25-50 lb / 5gal. / 20 kg	9-1/2" (241 mm)	11-11/32" (288 mm)	1" (25 mm)	442-30
443-24	25-50 lb / 5gal. / 20 kg	9-1/2" (241 mm)	11-11/32" (288 mm)	1.08" (27.5 mm)	454-00
478-22	25-50 lb / 5gal. / 20 kg	9-1/2" (241 mm)	11-11/32" (288 mm)	1-7/32" (31.3mm)	-
478-23	25-50 lb / 5gal. / 20 kg	9-1/2" (241 mm)	11-11/32" (288 mm)	1-13/32" (36mm)	-
443-30	25-50 lb / 5gal. / 20 kg	9-1/2" (241 mm)	11-11/32" (288 mm)	1.16" (29.5 mm)	454-10, 454-15, 454-36
478-24	25-50 lb / 5gal. / 20 kg	9-1/2" (241 mm)	11-11/32" (288 mm)	1-9/16" (40mm)	-
443-25	120lb. / 16 gal. / 50 kg	12.11/16" (322 mm)	15" (380 mm)	1.1/2" (38 mm)	442-20
478-25	120lb. / 16 gal. / 50 kg	12.11/16" (322 mm)	15" (380 mm)	1" (25 mm)	-
443-26	120lb. / 16 gal. / 50 kg	12.11/16" (322 mm)	15" (380 mm)	1.08" (27.5 mm)	454-01
478-26	120lb. / 16 gal. / 50 kg	12.11/16" (322 mm)	15" (380 mm)	1-7/32" (31.3mm)	-
443-31	120lb. / 16 gal. / 50 kg	12.11/16" (322 mm)	15" (380 mm)	1.16" (29.5 mm)	454-11, 454-16, 454-37
443-33	400 lb / 180 kg	21-5/8" (550 mm)	23-11/16" (602 mm)	1.16" (29.5 mm)	454-12, 454-17

Caution: Above recommendations may not work with all containers of similar capacity. Due to difference in lube container specifications from one company to another, there can be a difference in your container size. Above recommendations are based on most widely used container specifications worldwide. Pls. ensure that your lube container falls within the above specified follower plate dimensions, for using standard parts. Other follower plate sizes can be made on request.

71

FEMALE LOADER ADAPTORS

Female adaptors are mounted on Grease Filler pumps for bulk filling Grease Guns

Male Loader fitting on Grease Gun fits onto the female loader adaptor with the rubber seal in the adapter making the transfer leak-proof

Adaptors are threaded 1/4" NPT (F)



443-61
Universal Bulk Loader Valve
This dual-purpose adaptor can be used with both 9 mm Straight & American Tapered 0.58" (14.7 mm) Bulk Loader Valves
The top sleeve adapts to 9mm straight loader valves, which may be removed, and the base used with the larger 0.58" (14.7 mm) loader fittings



443-60
Adaptor for American Bulk Loader Valves only.
These are designed for use with American Tapered 0.58" (14.7 mm) Bulk Loader Valves



Female Loader
Adaptor mounted on
Grease Filler Pump

PART NR.	TYPE
443-60	For American Tapered 0.58"(14.7 mm) loader valves
443-61	Universal Adaptor for use with both 9 mm Straight & tapered 0.58" (14.7 mm) loader valves